

THE SOUTHEND BOROUGH COUNCIL (WAITING, LOADING, STOPPING AND PARKING PLACES) (MAP BASED) (CONSOLIDATION) ORDER 2021

THE SOUTHEND-ON-SEA CITY COUNCIL (WAITING, LOADING, STOPPING AND PARKING PLACES) (MAP BASED) (ST LAURENCE JUNCTION PROTECTION PHASE 1) AMENDMENT NO.5 ORDER 2024

Southend-on-Sea City Council in exercise of its powers under Sections 1, 2, 4 and 122 under the Road Traffic Regulation Act 1984 (as amended) (“the 1984 Act”) and the Traffic Management Act 2004 (“the 2004 Act”) and of all other enabling powers, and after consultation with the Chief Officer of Police in accordance with Part III and Part IV of Schedule 9 to the 1984 Act, hereby makes the following Order:

1. Without prejudice to the validity of anything done or to the liability incurred in respect of any act or omission before the coming into operation of this Order, The Southend Borough Council (Waiting, Loading, Stopping and Parking Places) (Map Based) (Consolidation) Order 2021 (as amended) (To be known as ‘The 2021 Order’) shall have effect as though;
 - (i) The items represented on the plans in Schedule 1 to this Order shall replace those corresponding plans as listed in the appropriate Schedule to the 2021 Order (as amended).
2. The effect of this Order is to introduce junction protection restrictions - No Waiting at Any Time (double yellow lines) and No Loading or Unloading at Any Time (double yellow kerb blip markings) for 10 metres at each of the junctions (both sides of every road) listed below:
 - Aldrin Way with Neil Armstrong Way
 - Avro Road with Eastwoodbury Lane
 - Bristol Road with Eastwoodbury Lane
 - Derek Gardens with Alton Gardens (north)
 - Derek Gardens with Alton Gardens (south)
 - Fulford Drive with Whitehouse Road
 - Fulford Drive with Meakins Close
 - Meakins Close with Blatches Chase
 - Oakengrange Drive with Alton Gardens
 - Oakengrange Drive with Hampton Gardens
 - Vickers Road with Eastwoodbury Lane
 - Whitehouse Meadows with Whitehouse Road

On the junction of Comet Way with Comet Way; to revoke 10 metres of the current No Waiting, Mon-Fri, 6am-6pm restrictions and introduce junction protection restrictions - No Waiting at Any Time (double yellow lines) and No Loading or Unloading at Any Time (double yellow kerb blip markings).

3. The remainder of The Southend Borough Council (Waiting, Loading, Stopping and Parking Places) (Map Based) (Consolidation) Order 2021 (as amended) shall remain in full force and effect.
4. This Order shall come into effect on the 17th day of October 2024 and may be cited as “The Southend Borough Council (Waiting, Loading, Stopping and Parking Places) (Map Based) (Consolidation) Order 2021. The Southend-on-Sea City Council (Waiting, Loading, Stopping and Parking Places) (Map-Based) (St Laurence Junction Protection Phase 1) Amendment No.5 Order 2024.”

Given under the Common Seal of Southend-on-Sea City Council the 16th day of October 2024.

THE COMMON SEAL of
SOUTHEND-ON-SEA CITY COUNCIL

was hereunto affixed

in the presence of:

A handwritten signature in black ink, appearing to read 'Richard Lumley', written in a cursive style.

Richard Lumley

Director of Infrastructure and Environment

Schedule 1

(1)

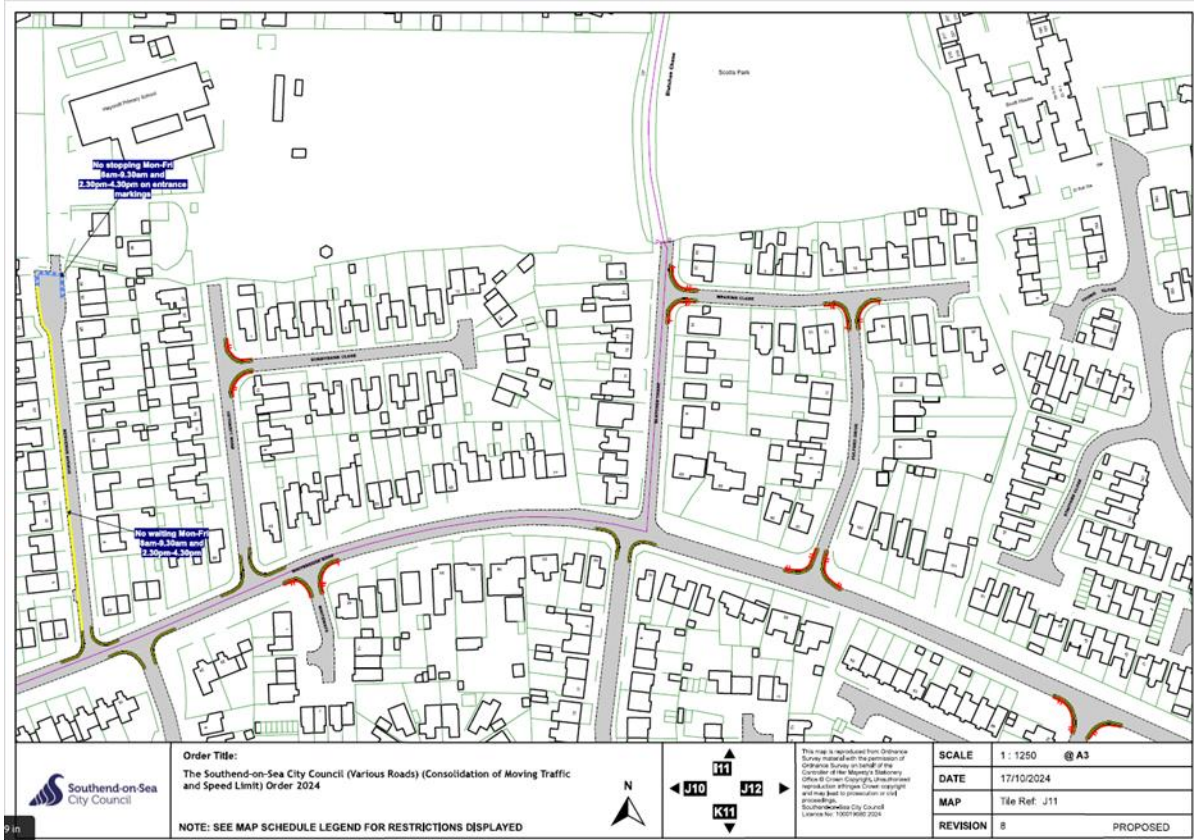

Order Title:
 The Southend-on-Sea City Council (Various Roads) (Consolidation of Moving Traffic and Speed Limits) Order 2024

NOTE: SEE MAP SCHEDULE LEGEND FOR RESTRICTIONS DISPLAYED

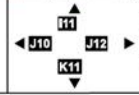

This map is reproduced from Ordnance Survey material with the permission of Ordnance Survey on behalf of the Controller of Her Majesty's Stationery Office © Crown Copyright. Unauthorised reproduction without Crown copyright will map best to prosecution or civil proceedings.
 Southend-on-Sea City Council
 Licence No. 100018827 2024

SCALE	1 : 1250	@ A3
DATE	17/10/2024	
MAP	Title Ref. J11	
REVISION	8	PROPOSED

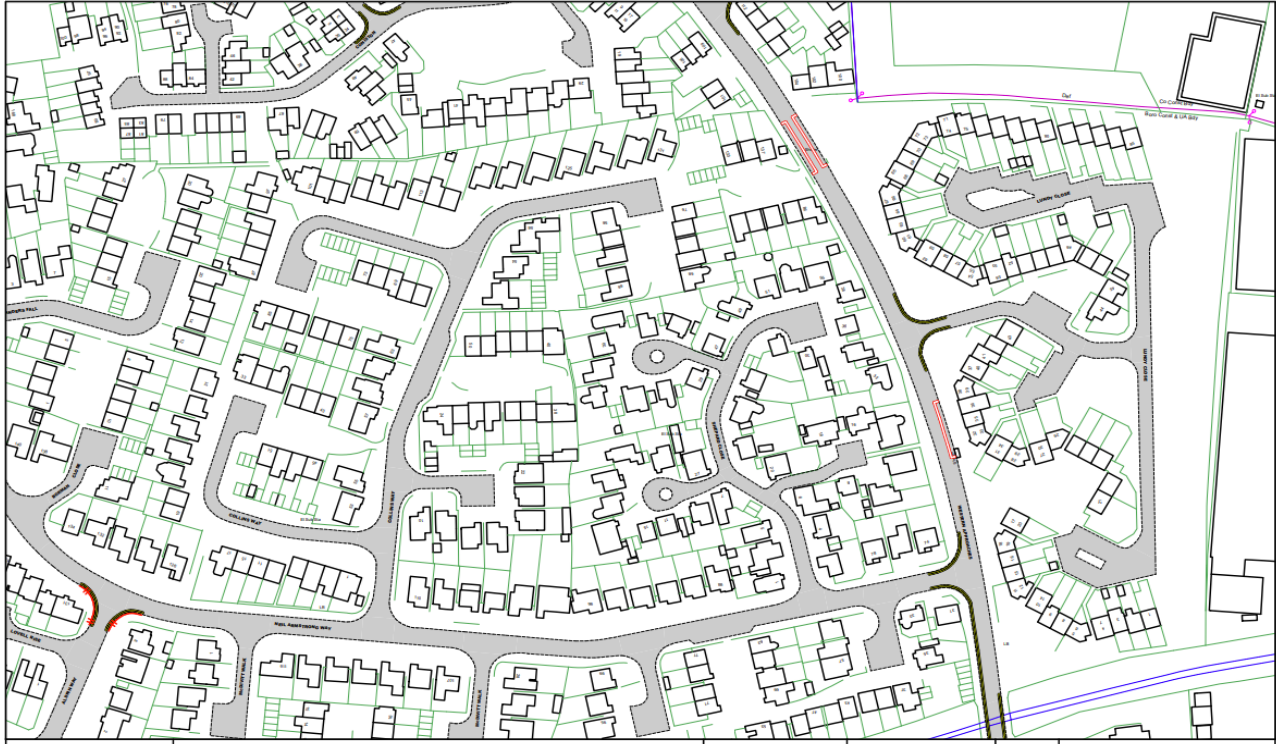

Order Title:
The Southend-on-Sea City Council (Various Roads) (Consolidation of Moving Traffic and Speed Limit) Order 2024

NOTE: SEE MAP SCHEDULE LEGEND FOR RESTRICTIONS DISPLAYED

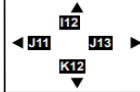

This map is reproduced from Ordnance Survey material with the permission of Ordnance Survey on behalf of the Controller of Her Majesty's Stationery Office © Crown Copyright. Unauthorised reproduction infringes Crown copyright and may lead to prosecution or civil proceedings.
 Southend-on-Sea City Council
 Licence No: 100019860 2024

SCALE	1 : 1250 @ A3
DATE	17/10/2024
MAP	Title Ref: J12
REVISION	6 PROPOSED

(2)

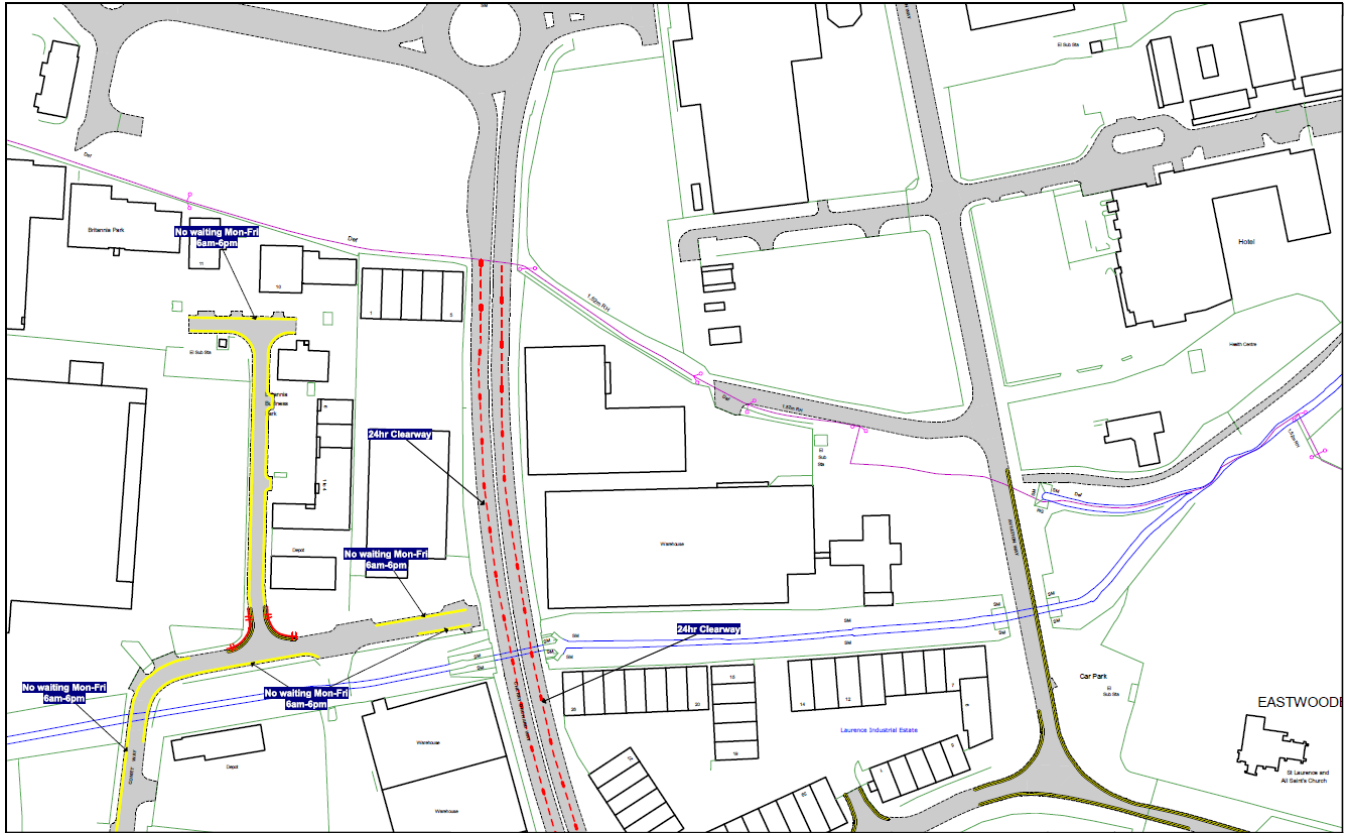

Order Title:
The Southend-on-Sea City Council (Various Roads) (Consolidation of Moving Traffic and Speed Limit) Order 2024

NOTE: SEE MAP SCHEDULE LEGEND FOR RESTRICTIONS DISPLAYED

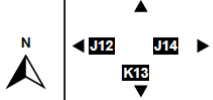

This map is reproduced from Ordnance Survey material with the permission of Ordnance Survey on behalf of the Controller of Her Majesty's Stationery Office © Crown Copyright. Unauthorised reproduction infringes Crown copyright and may lead to prosecution or civil proceedings.
 Southend-on-Sea City Council
 Licence No: 100019980/2024

SCALE	1 : 1250 @ A3
DATE	17/10/2024
MAP	Tile Ref: J13
REVISION	5 PROPOSED

(3)



Order Title:
The Southend-on-Sea City Council (Various Roads) (Consolidation of Moving Traffic and Speed Limit) Order 2024

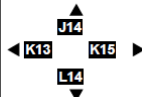

This map is reproduced from Ordnance Survey material with the permission of Ordnance Survey on behalf of the Controller of Her Majesty's Stationery Office. © Crown Copyright. Unauthorised reproduction infringes Crown copyright and may lead to prosecution or civil proceedings.
 Southend-on-Sea City Council
 Licence No: 100019980 2024

SCALE	1 : 1250	@ A3
DATE	17/10/2024	
MAP	Tile Ref: K14	
REVISION	6	PROPOSED

NOTE: SEE MAP SCHEDULE LEGEND FOR RESTRICTIONS DISPLAYED

(4)

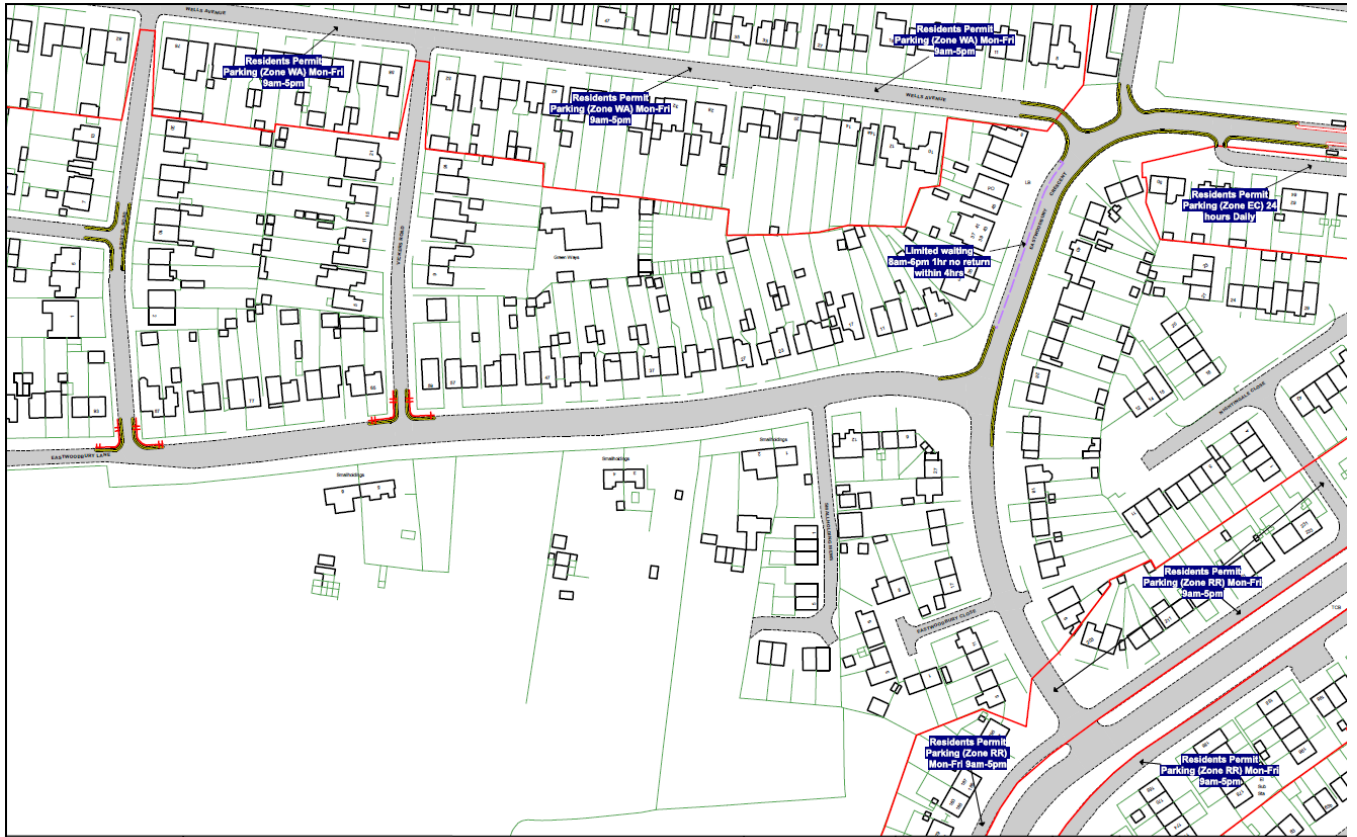

Order Title:
The Southend-on-Sea City Council (Various Roads) (Consolidation of Moving Traffic and Speed Limit) Order 2024

NOTE: SEE MAP SCHEDULE LEGEND FOR RESTRICTIONS DISPLAYED

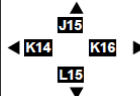

This map is reproduced from Ordnance Survey materials with the permission of Ordnance Survey on behalf of the Controller of Her Majesty's Stationery Office © Crown Copyright. Unauthorised reproduction (including Crown copyright) and may lead to prosecution or civil proceedings.
 Southend-on-Sea City Council
 Licence No: 100019980 2024

SCALE	1 : 1250 @ A3
DATE	17/10/2024
MAP	Tile Ref: K15
REVISION	6 PROPOSED

(5)

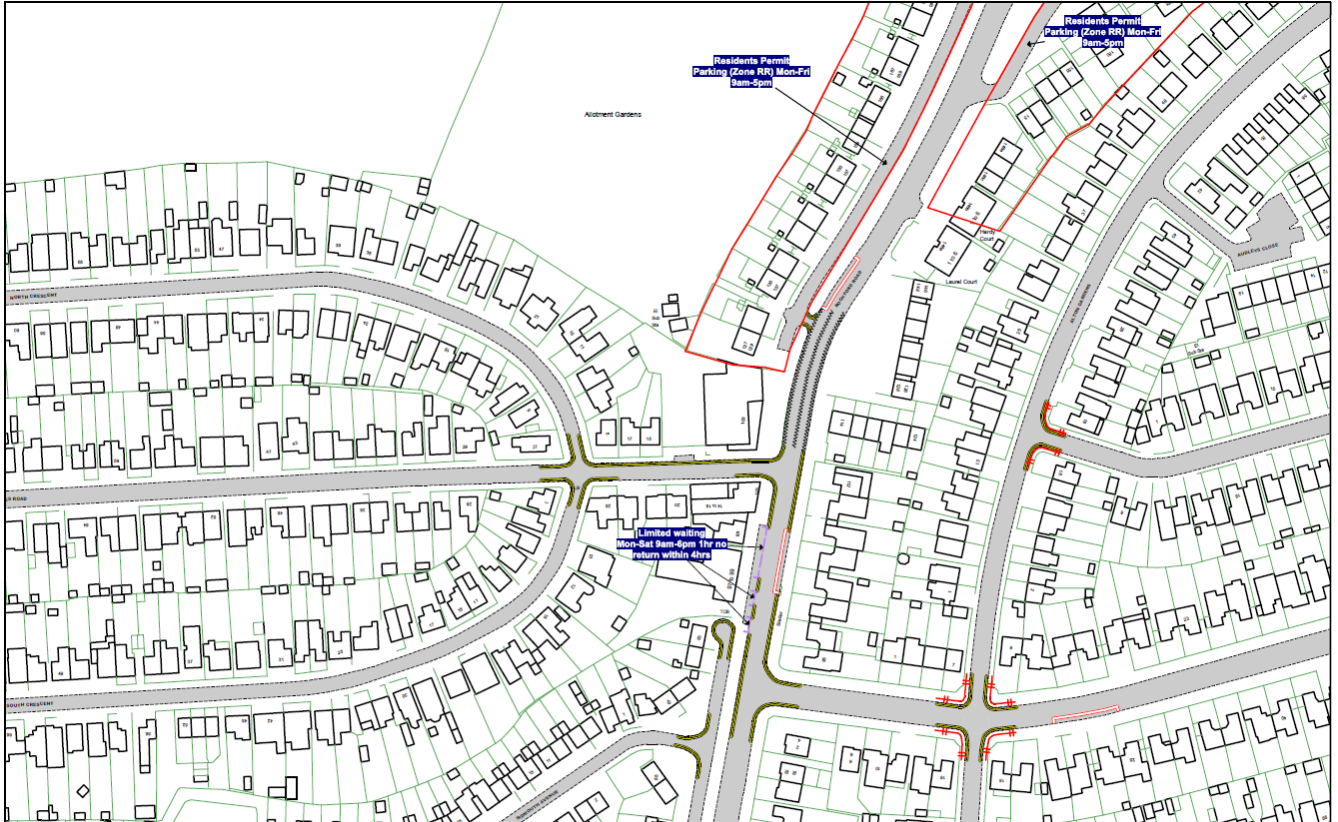

Order Title:
The Southend-on-Sea City Council (Various Roads) (Consolidation of Moving Traffic and Speed Limit) Order 2024

N

NOTE: SEE MAP SCHEDULE LEGEND FOR RESTRICTIONS DISPLAYED

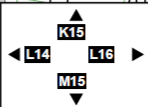

This map is reproduced from Ordnance Survey material with the permission of Ordnance Survey on behalf of the Controller of Her Majesty's Stationery Office © Crown Copyright. Unauthorised reproduction infringes Crown copyright and may lead to prosecution or civil proceedings.
 Southend-on-Sea City Council
 Licence No: 100019386-2024

SCALE	1 : 1250	@ A3
DATE	17/10/2024	
MAP	Tile Ref: L15	
REVISION	6	PROPOSED

(6)

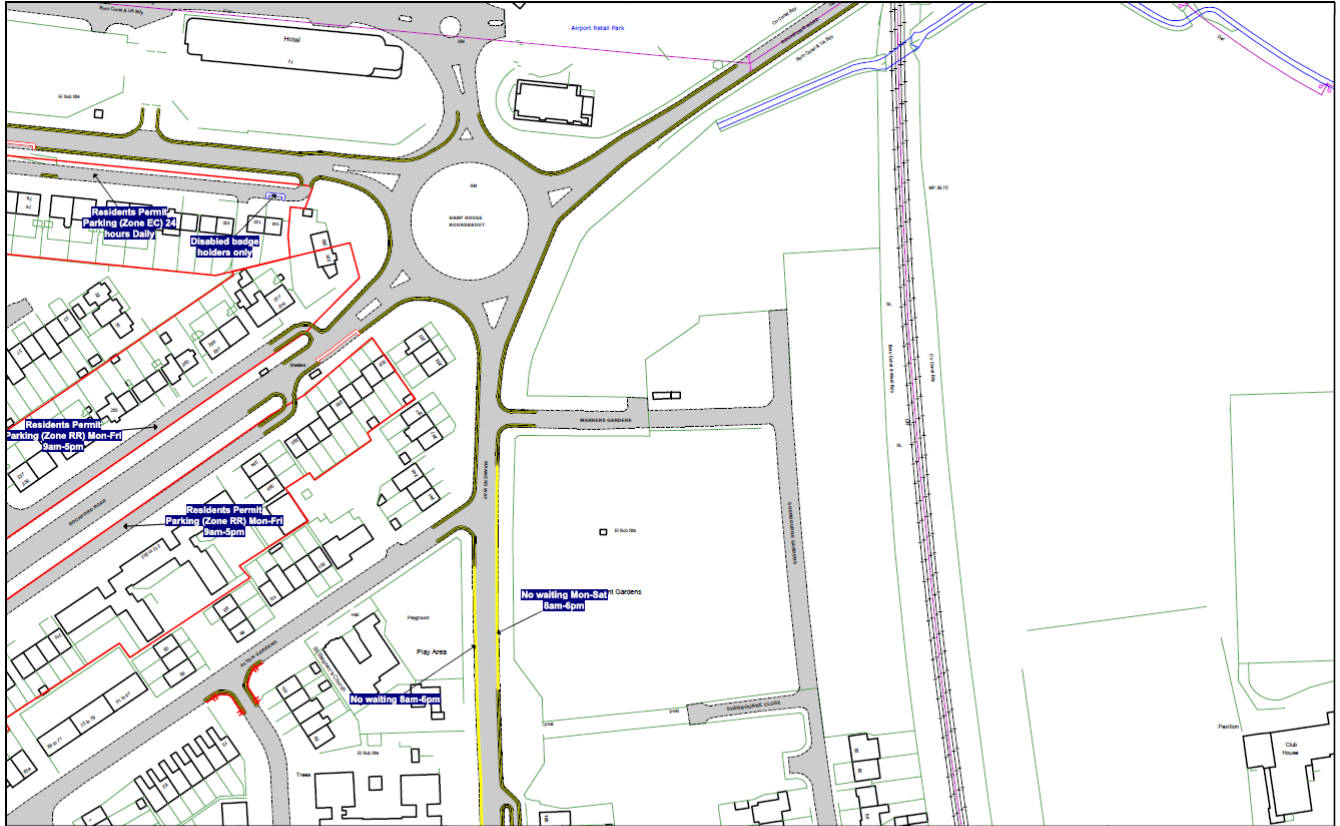

Order Title:
The Southend-on-Sea City Council (Various Roads) (Consolidation of Moving Traffic and Speed Limit) Order 2024

NOTE: SEE MAP SCHEDULE LEGEND FOR RESTRICTIONS DISPLAYED

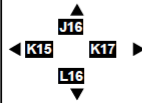

This map is reproduced from Ordnance Survey material with the permission of Ordnance Survey on behalf of the Controller of Her Majesty's Stationery Office. © Crown Copyright. Unauthorised reproduction infringes Crown copyright and may lead to prosecution or civil proceedings.
 Southend-on-Sea City Council
 Licence No: 100016980/2024

SCALE	1 : 1250 @ A3
DATE	17/10/2024
MAP	Tile Ref: K16
REVISION	6 PROPOSED

(7)