

CITY OF SOUTHEND-ON-SEA
THE SOUTHEND CITY COUNCIL (WAITING, LOADING, STOPPING AND PARKING PLACES)
(CONSOLIDATION) ORDER 2022

PTO1040 – Eastwood Park Junction Protections

1. NOTICE IS HEREBY GIVEN that Southend-on-Sea City Council proposes to make the amendments to the above Order under the Road Traffic Regulation Act 1984 as amended.
2. The general effect of the Orders will be:

To install junction protection; no waiting at any time (double yellow lines) **AND** no loading or unloading at any time (double yellow kerb blip markings) at approximately 10 metres at each of the junction locations below:

- | | |
|--|--|
| a) Alan Close with Alan Grove | hh) Macmurdo Close with Macmurdo Road |
| b) Alan Grove with Eastwood Park Drive | ii) Mansell Close with Hudson Crescent |
| c) Anstey Close with Wren Avenue | jj) Musket Grove with Belgrave Road |
| d) Belgrave Close with Belgrave Road | kk) Nobles Green Close with Nobles Green Road |
| e) Bolney Drive with Ringwood Drive | ll) Paddock Close with Kendal Way |
| f) Bowman Road with Cornec Chase | mm) Paddock Close with Paddock Close |
| g) Bramble Road with Grove Hill | nn) Ringwood Drive with Cornec Avenue |
| h) Brookfields with Pinewood Avenue | oo) Riverdale with Green Lane |
| i) Brookfields Close with Brookfields | pp) Rowan Walk with Hudson Road |
| j) Chanton Close with Dandies Drive | qq) Rowan Walk with Rowan Walk |
| k) Chesterfield Crescent with Pinewood Avenue | rr) Saffory Close with Saffory Close |
| l) Chesterfield Crescent with Pinewood Avenue | ss) Sairard Close with Sairard Gardens |
| m) Cornec Avenue with Belgrave Road | tt) Southernhay with Pinewood Avenue |
| n) Cornec Chase with Cornec Avenue | uu) Southernhay with Brookfields |
| o) Dandies Chase with Dandies Drive | vv) Springwater Close with Springwater Grove |
| p) Dandies Close with Dandies Drive | ww) Springwater Grove with Springwater Road |
| q) Dering Crescent with Dering Crescent | xx) Springwater Road with Tudor Road |
| r) Eastwood Park Close with Eastwood Park Drive | yy) St Laurence Gardens with St Lawrence Court |
| s) Eastwood Park Drive with Fairfield Road | zz) St Lawrence Gardens with Lambeth Road |
| t) Epping Close with Nobles Green Road | aaa) Steeplefield with Rowan Walk |
| u) Fairfield Crescent with the junction with Fairfield Gardens | bbb) Steeplefield with Steeplefield |
| v) Fairfield Gardens with Fairfield Road | ccc) Steeplefield with Steeplefield |
| w) Flemings Farm Road with Green Lane | ddd) Steeplefield with Steeplefield |
| x) Gipson Park Close with Gipson Park Close | eee) Steeplefield with Lambeth Road |
| y) Gravel Road with Eastwood Rise | fff) Sunnybank Close with Heycroft Road |
| z) Gravel Road with Eastwood Rise | ggg) Symons Avenue with Symons Avenue |
| aa) Grove Hill with Belgrave Road | hhh) Symons Avenue with Symons Avenue |
| bb) Grovewood Close with Grovewood Avenue | iii) Symons Avenue with Nobles Green Road |
| cc) Hartland Close with Dandies Drive | jjj) The Crest with The Crest |
| dd) Hazelwood Grove with Priory Wood Crescent | kkk) The Green with Eastwood Park Drive |
| ee) Hazelwood Grove with A127 Southend Arterial Road | lll) The Spinneys with Green Lane |
| ff) Hudson Crescent with St Lawrence Gardens | mmm) Tudor Close with Gravel Road |
| gg) Kendal Way with Green Lane | nnn) Tudor Road with Gravel Road |
| | ooo) Whiteways with Whitehouse Road |
| | ppp) Winchester Close with Parkway Close |
| | qqq) Wren Close with Wren Close |

3. Copies of the draft Orders, detailed location plans and the Statement of Reasons may be viewed at the Civic Centre (address below) during normal office hours. Documents can also be viewed online at: <https://www.southend.gov.uk/tro.or>
<http://www.southendtraffweb.co.uk/consult/main.html>
4. Comments on the proposals together with the reasons for which they are made must be in writing to the Business Change and Development Team at the address below or by email to traffweb@southend.gov.uk by no later than **10 June 2022**.
5. All written representations received concerning Traffic Regulation Orders are public documents that may be inspected by any person on demand.

Dated: 20 May 2022

S. Harrington
Head of Traffic and Highways

Civic Centre, Victoria Avenue, Southend-on-Sea, Essex, SS2 6ER

CITY OF SOUTHEND-ON-SEA
THE SOUTHEND-ON-SEA CITY COUNCIL (WAITING, LOADING, STOPPING AND
PARKING PLACES) (CONSOLIDATION) (AMMENDMENT NO.8) ORDER 2021
PTO1040 – Phase 1 – Eastwood Park Ward Junction Protections

Southend-on-Sea City Council on 19 September 2022 made the above-mentioned Order under the Road Traffic Regulation Act 1984 (as amended) and the Traffic Management Act 2004 (as amended) proposes to make the following Orders under the Road Traffic Regulation Act 1984 (as amended):

1. The general effect of the Orders will be:-

To install junction protection; no waiting at any time (double yellow lines) **AND** no loading or unloading at any time (double yellow kerb blip markings) at approximately 10 metres at each of the junction locations below:

- | | |
|---|--|
| a) Anstey Close with Wren Avenue | t) Paddock Close with Kendal Way |
| b) Belgrave Close with Belgrave Road | u) Ringwood Drive with Cornec Avenue |
| c) Bolney Drive with Ringwood Drive | v) Rowan Walk with Hudson Road |
| d) Bramble Road with Grove Hill | w) Sairard Close with Sairard Gardens |
| e) Brookfields with Pinewood Avenue | x) Southernhay with Pinewood Avenue |
| f) Chesterfield Crescent with Pinewood Avenue (Northern and Southern) | y) Springwater Grove with Springwater Road |
| g) Cornec Chase with Cornec Avenue | z) St Laurence Gardens with St Lawrence Court |
| h) Dandies Chase with Dandies Drive | aa) St Lawrence Gardens with Lambeth Road |
| i) Dandies Close with Dandies Drive | bb) Steeplefield with Rowan Walk |
| j) Eastwood Park Close with Eastwood Park Drive | cc) Steeplefield with Steeplefield (Eastern) |
| k) Eastwood Park Drive with Fairfield Road | dd) Sunnybank Close with Heycroft Road |
| l) Epping Close with Nobles Green Road | ee) Symons Avenue with Symons Avenue (Eastern) |
| m) Flemings Farm Road with Green Lane | ff) Symons Avenue with Nobles Green Road |
| n) Grove Hill with Belgrave Road | gg) The Crest with The Crest |
| o) Grovewood Close with Grovewood Avenue | hh) The Green with Eastwood Park Drive |
| p) Hazelwood Grove with Priory Wood Crescent | ii) The Spinneys with Green Lane |
| q) Kendal Way with Green Lane | jj) Tudor Close with Gravel Road |
| r) Mansell Close with Hudson Crescent | kk) Tudor Road with Gravel Road |
| s) Musket Grove with Belgrave Road | ll) Winchester Close with Parkway Close |
| | mm) Wren Close with Wren Close |

2. A copy of the Orders, which will come into operation on 19 September 2022 and all relevant documents can also be viewed online at www.southend.gov.uk/tro until the end of six weeks from the date on which the Orders were made.
3. Any person wishing to question the validity of the Orders or of any provision contained therein on the grounds that it is not within the relevant powers of the Road Traffic Regulation Act 1984, or that any relevant requirements thereof or any regulations made thereunder has not been complied with in relation to the Orders may, within six weeks of the date on which the Orders were made, make application for the purpose to the High Court.
4. A copy of each of the made Orders and all relevant documents can be inspected on the Ground Floor of the Civic Centre (address below) during normal office hours.

Dated: 19 September 2022

S. Harrington
Head of Traffic and Highways

Civic Centre, Victoria Avenue, Southend-on-Sea, Essex. SS2 6ER

SOUTHEND-ON-SEA CITY COUNCIL
**THE SOUTHEND-ON-SEA CITY COUNCIL (WAITING, LOADING, STOPPING AND
PARKING PLACES) (CONSOLIDATION) (AMENDMENT No.8) ORDER 2021**

ROAD TRAFFIC REGULATION ACT 1984

Made: 19th September 2022

Coming into force: 19th September 2022

Southend-on-Sea City Council (hereinafter referred to as “the Council”) in exercise of powers under the Road Traffic Regulation Act 1984, (as amended) (“the Act”), and of all other enabling powers, and after consultation with the Chief Officer of Essex Police hereby make the following order:-

1. This Order shall come into operation on and may be cited as “The Southend -on-Sea City Council (Waiting, Loading, Stopping and Parking Places) (Consolidation) (Amendment No*) Order 2021 (PTO1040 – Phase 1).
2. “The Southend Borough Council (Waiting, Loading, Stopping and Parking Places) Consolidation Order 2021 (PTO1005)” (the 2021 Order) is amended as follows.

Amendments

3. Without prejudice to the validity of anything done or to the liability incurred in respect of any act or omission before the coming into operation of this Order the 2021 Order and shall have effect:-
 - a) the items represented on the plans in Schedule 1 to this Order shall replace those plans as listed in the appropriate Schedule to the 2021 Order.

Authorised Signature:

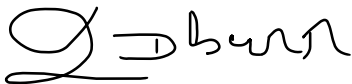

CITY COUNCIL was pursuant to a resolution
of the Council hereunto affixed this nineteenth day
of September Two Thousand and Twenty-Two
in the presence of:

John Burr
(Executive Director of Neighbourhoods and Environments – Interim)

NOTES:

The purpose of the proposals is to:-

- a) To introduce junction protection (no waiting at any time and no loading at any time restrictions in Eastwood Park Ward at the required junctions to improve safety. This is part of the City wide project.
- b) To amend the existing restrictions (no waiting at any time restrictions) to no waiting at any time and no stopping at any time restrictions in Eastwood Park Ward at the required junctions. This is also part of the City wide project.

Statement of Reasons for

Proposals: No Waiting at Any Time and No Loading at Any Time restrictions at the required junctions in Eastwood Park Ward

- a) To ensure the highest level of safety at each junction across the city of Southend; achieving this by maximising visibility and access for emergency vehicles.

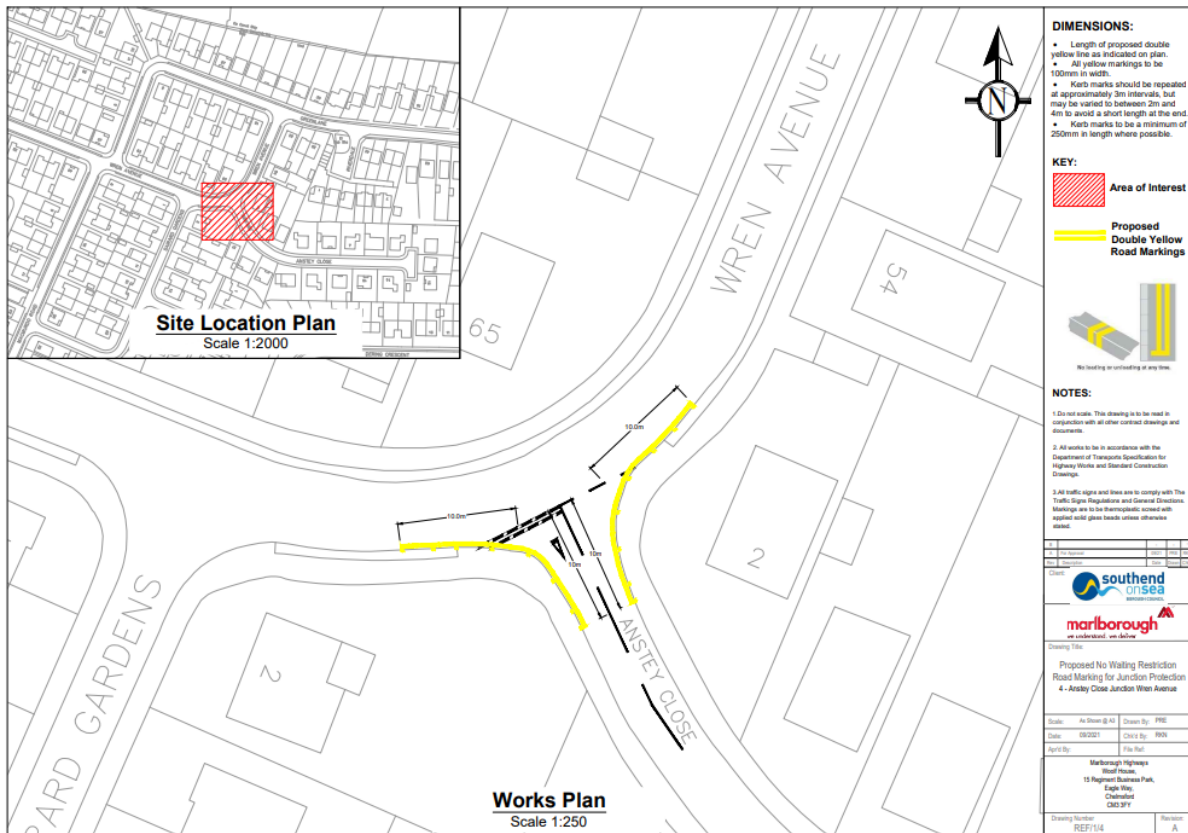
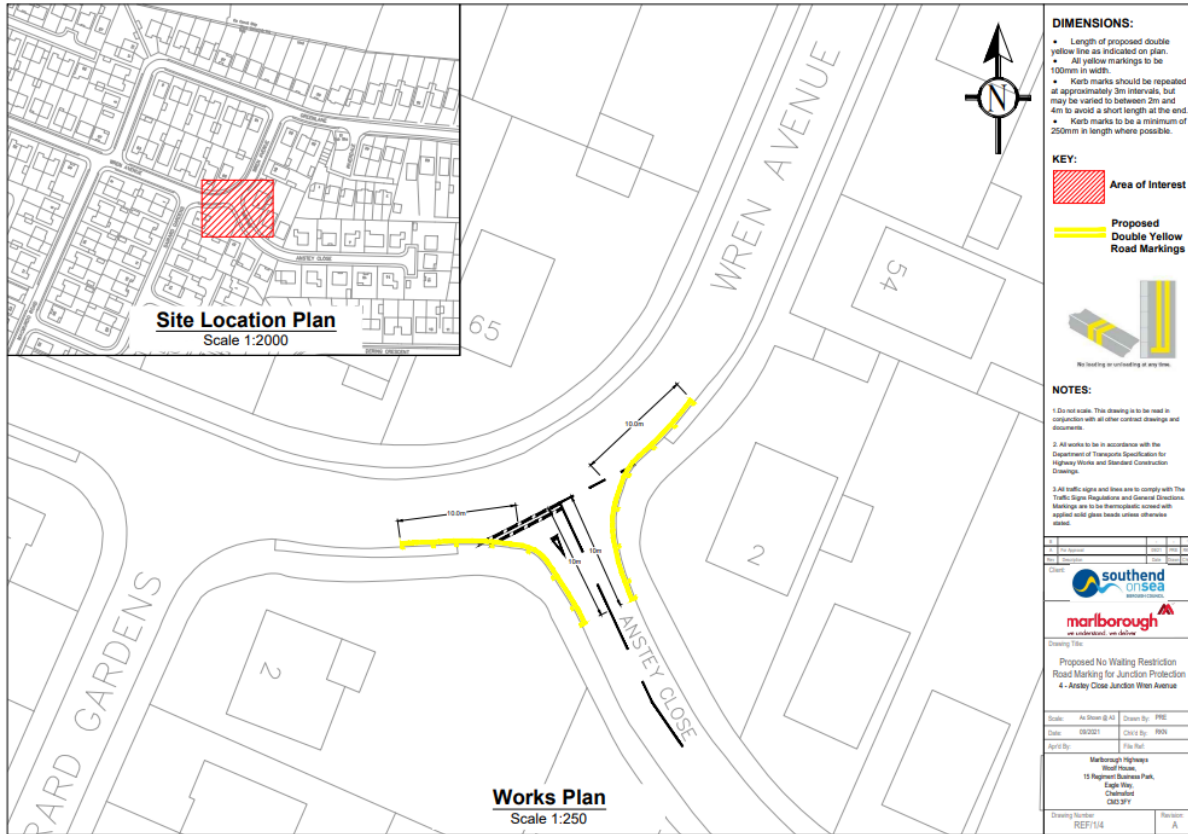

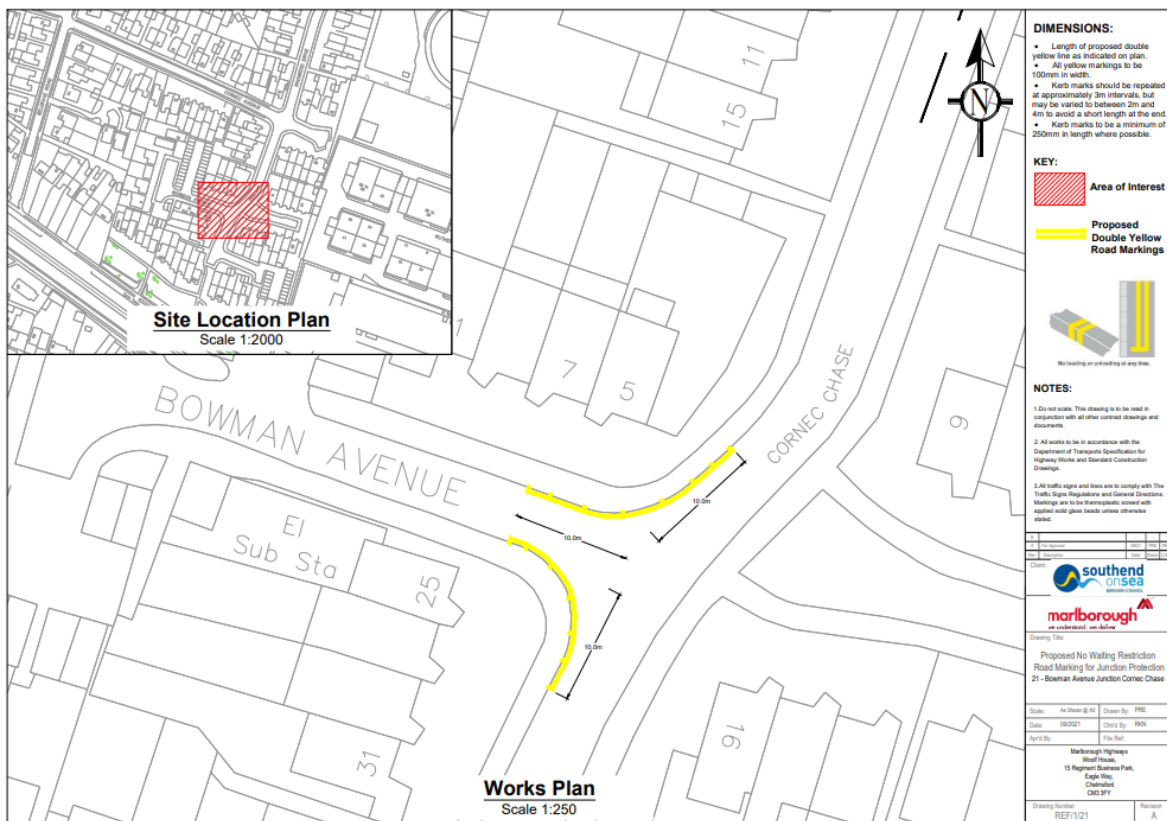
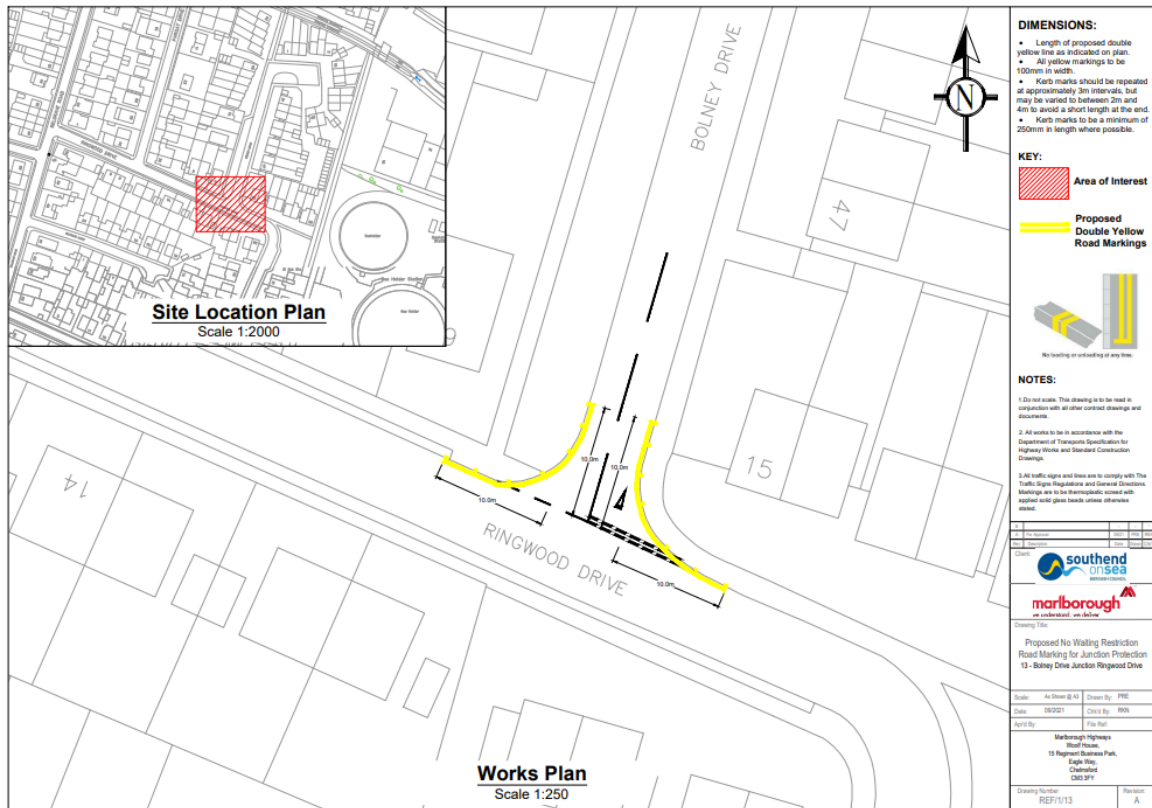

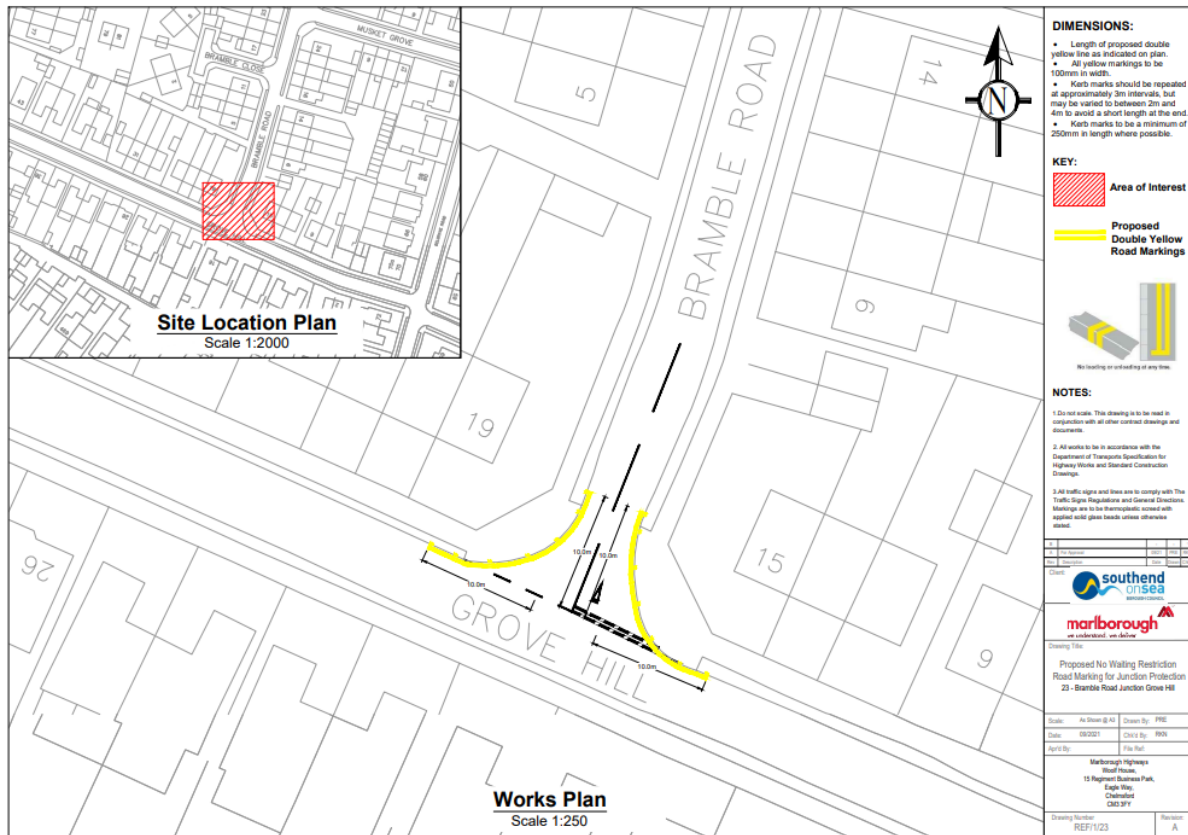

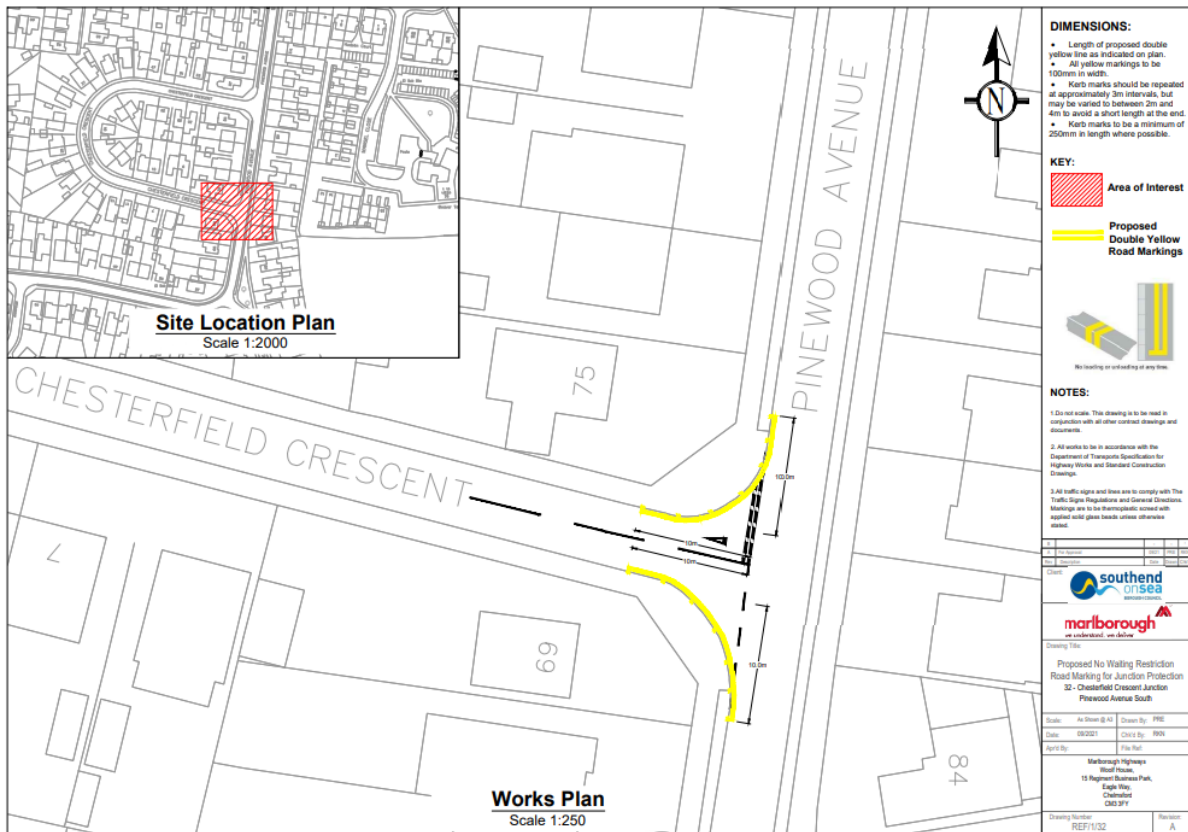
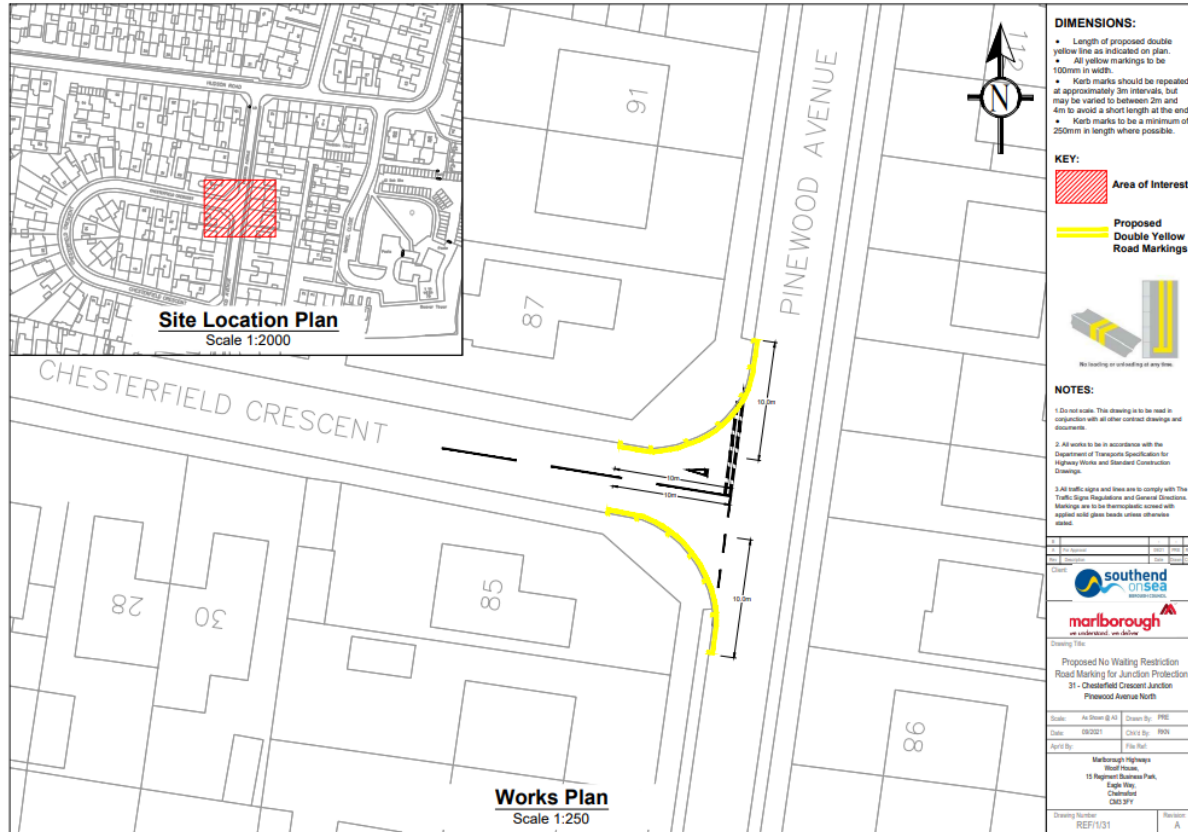

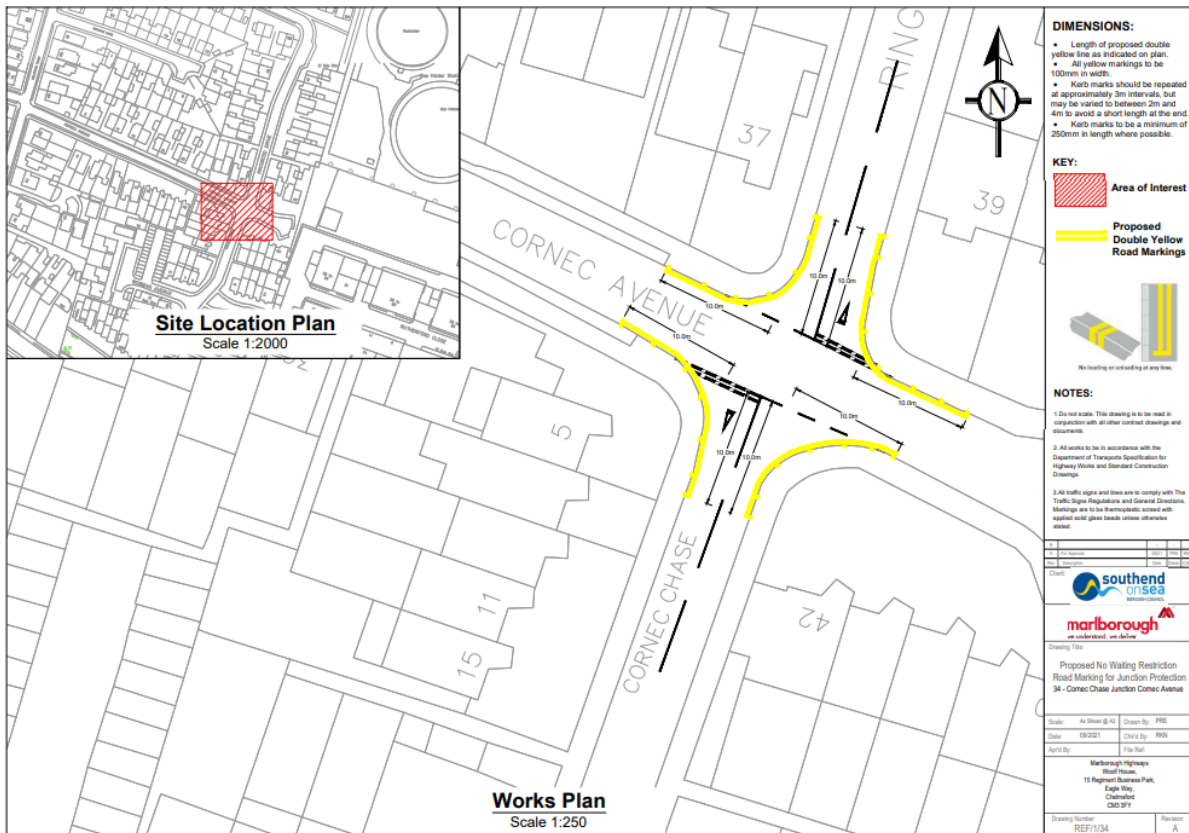
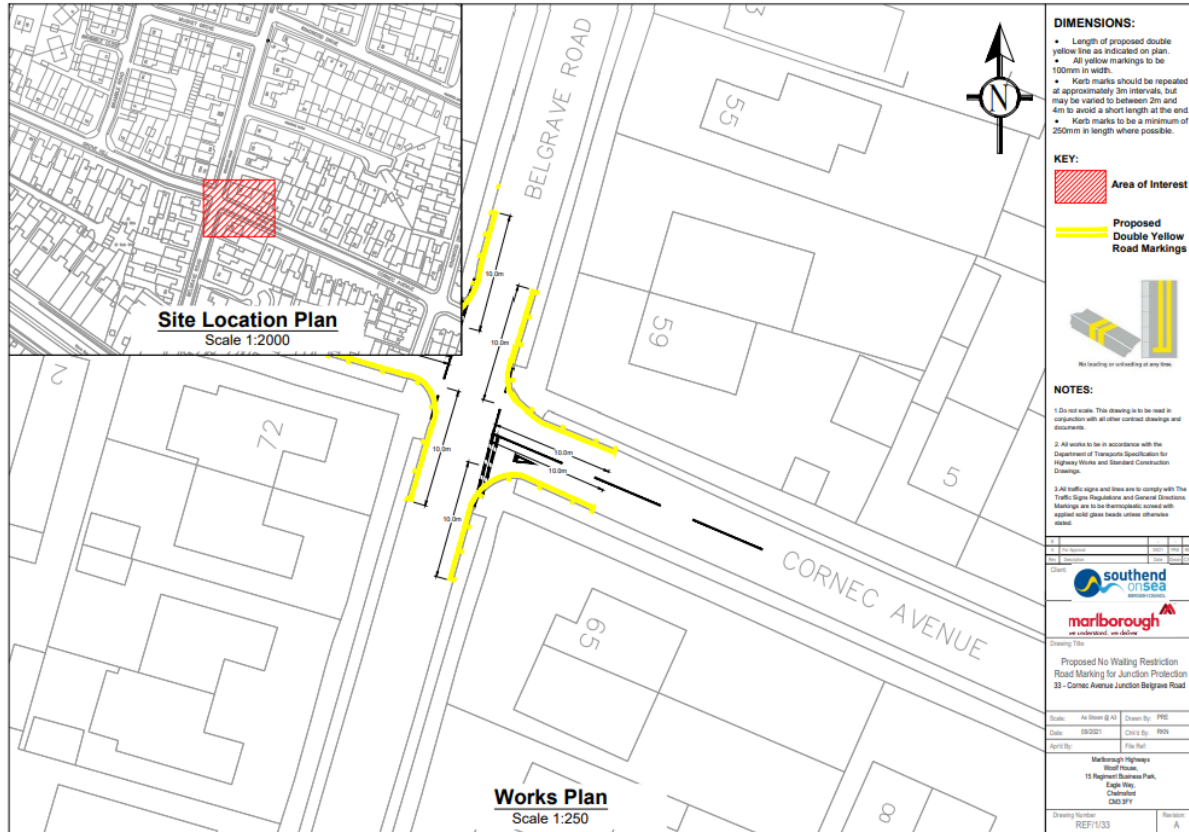

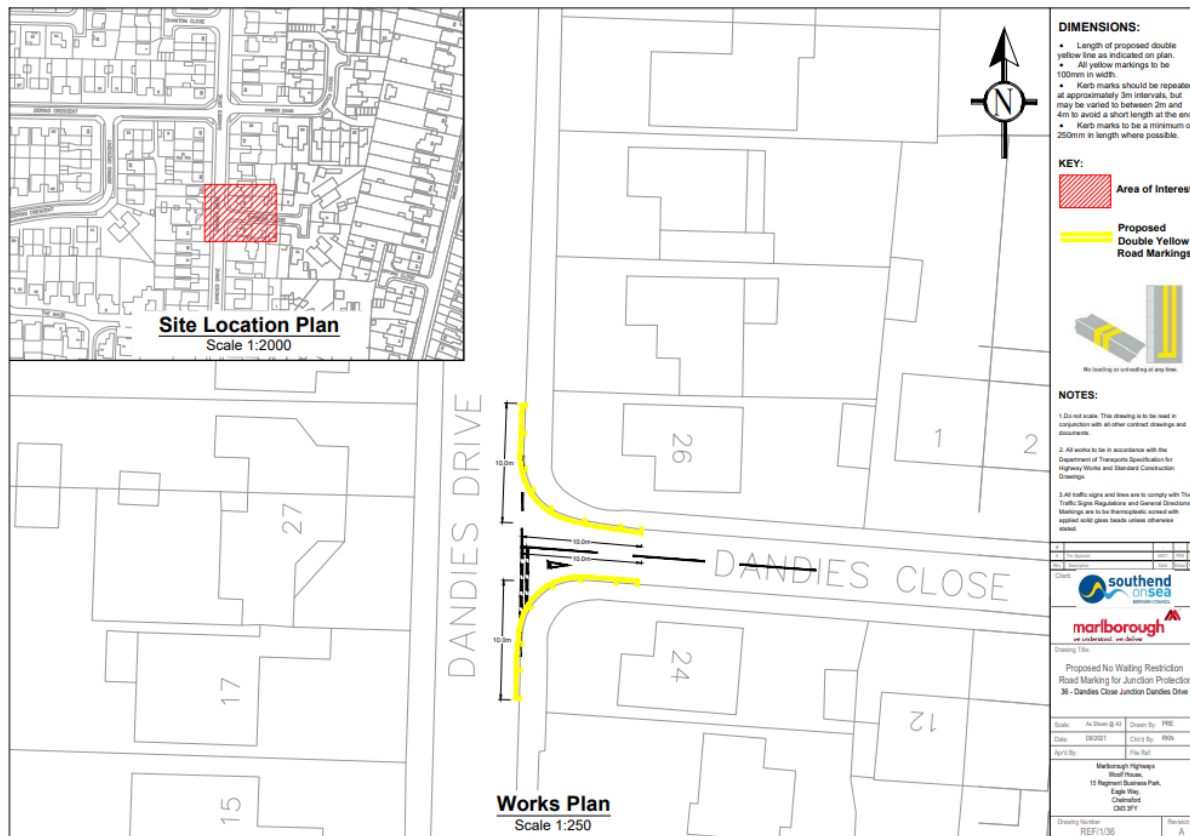
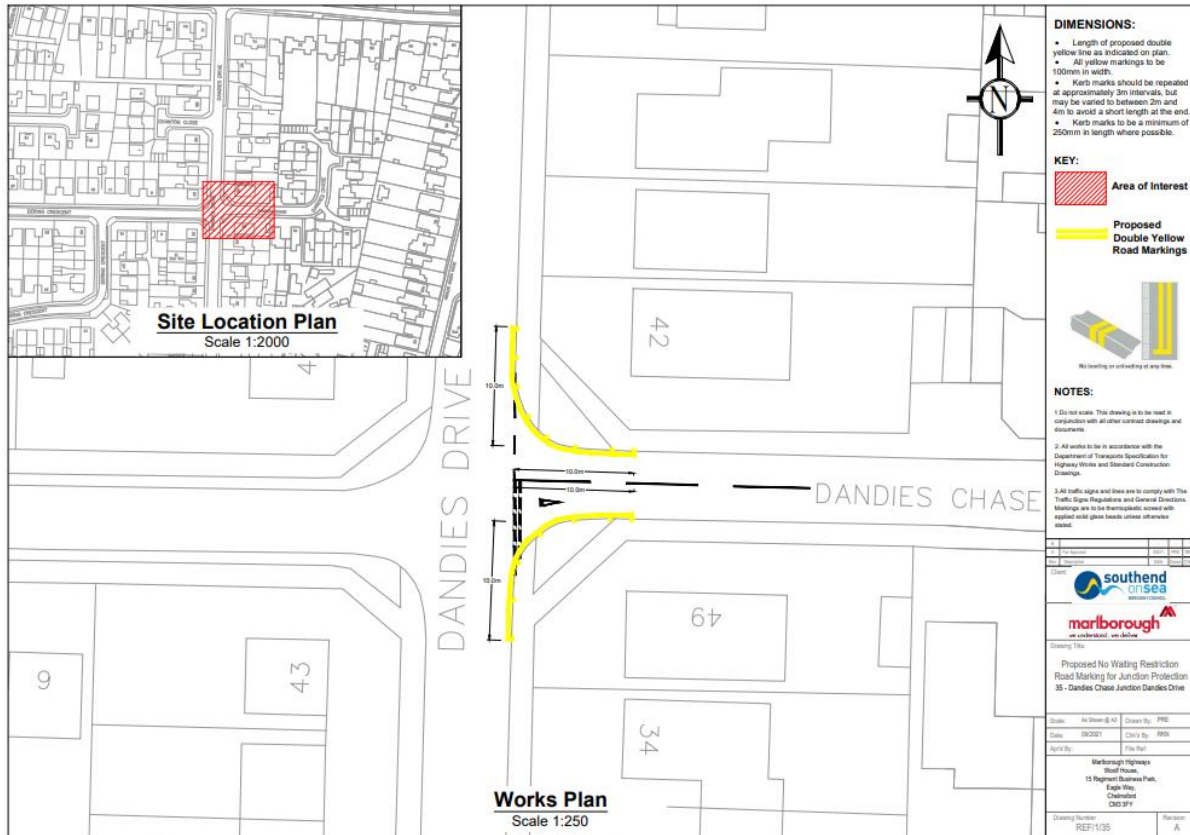

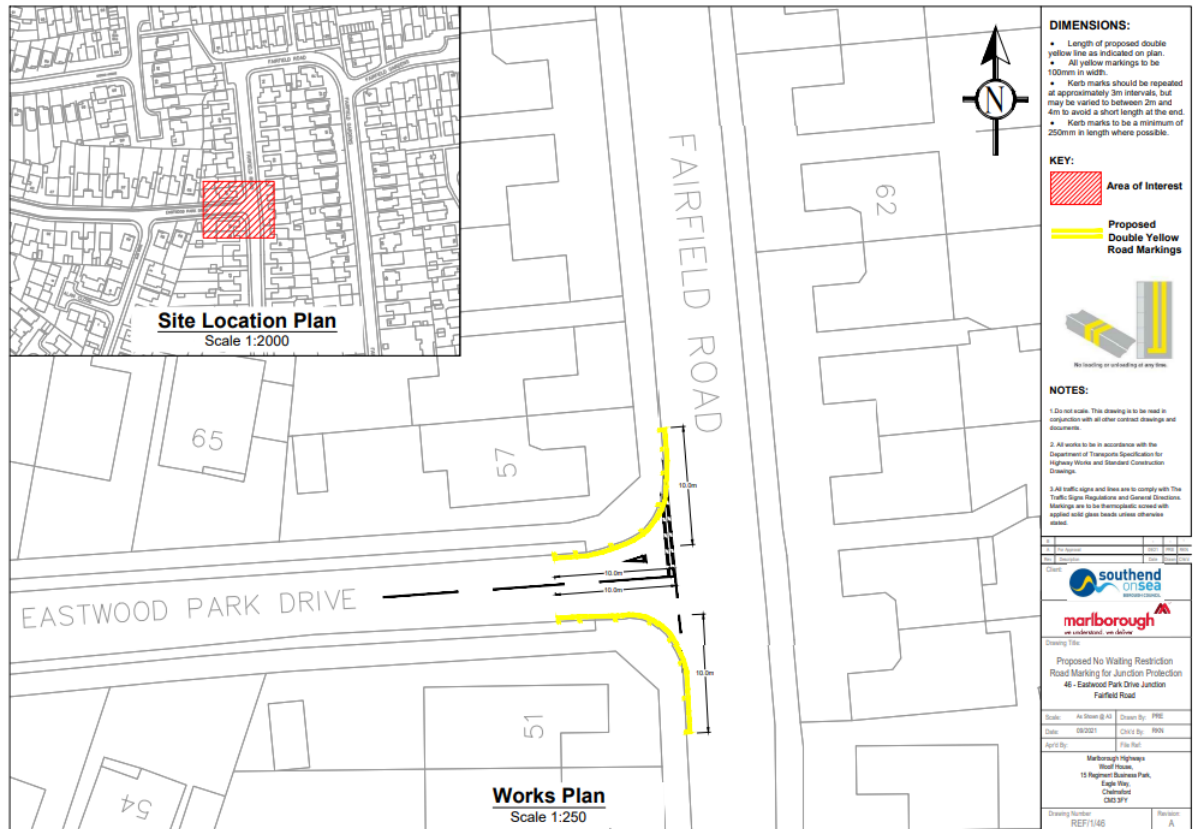
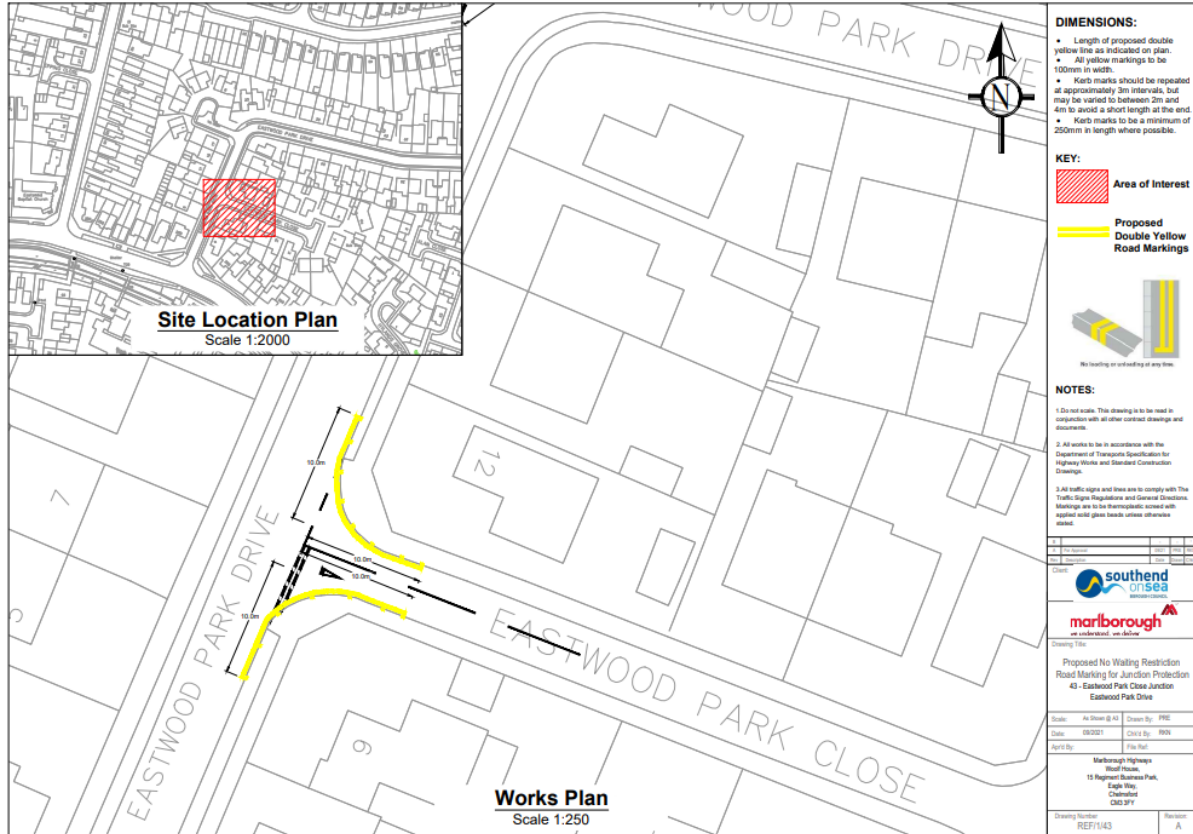

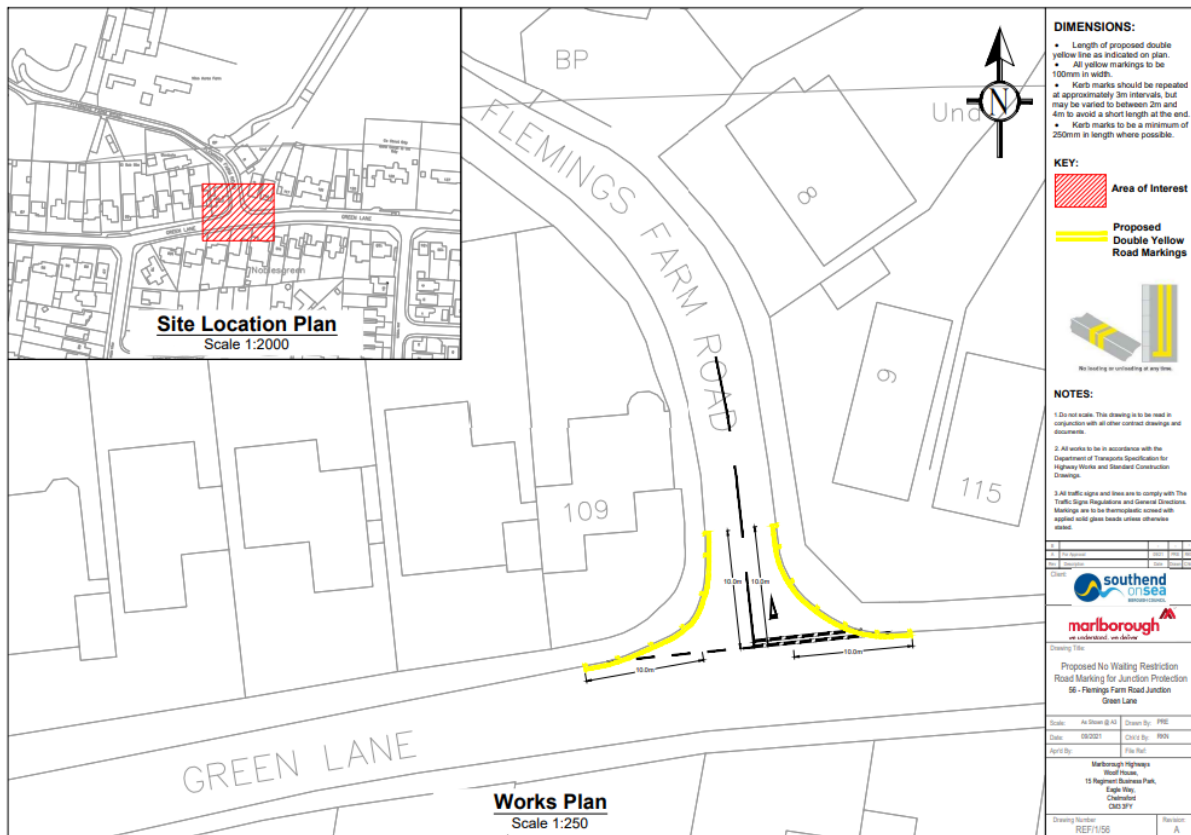
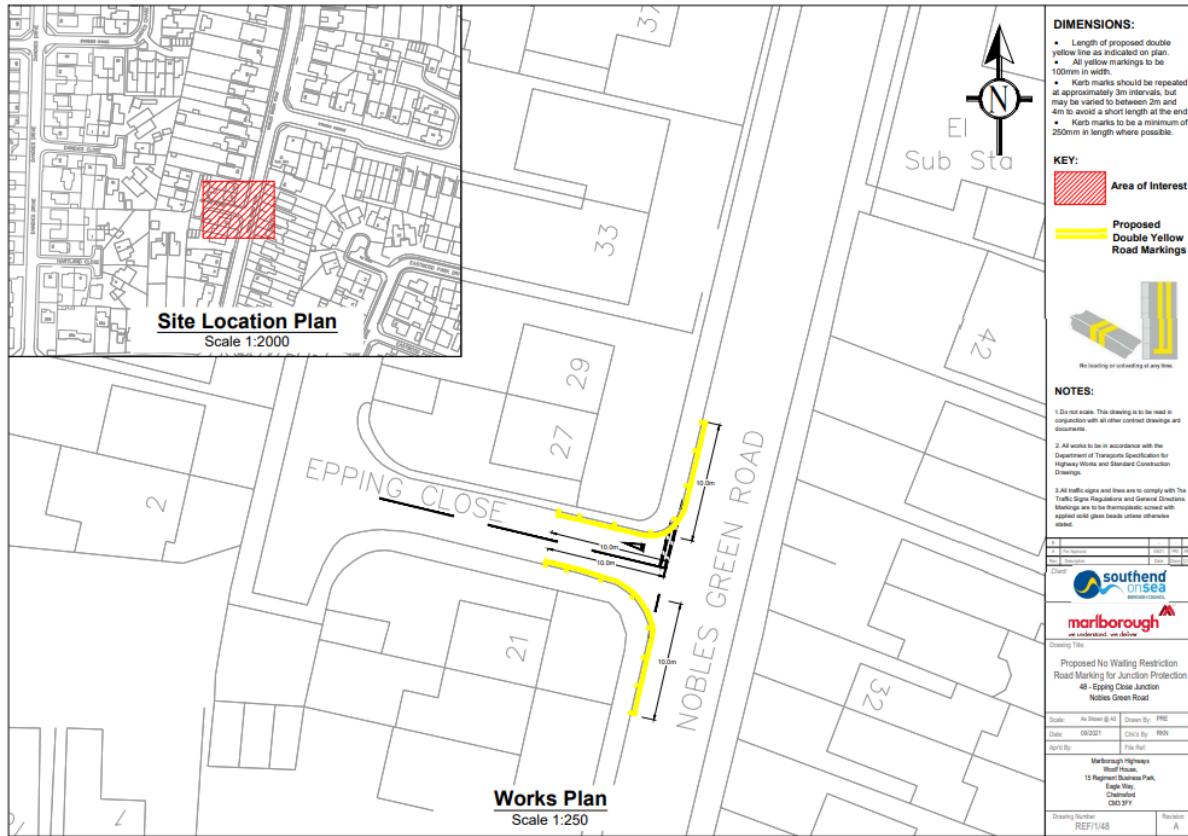

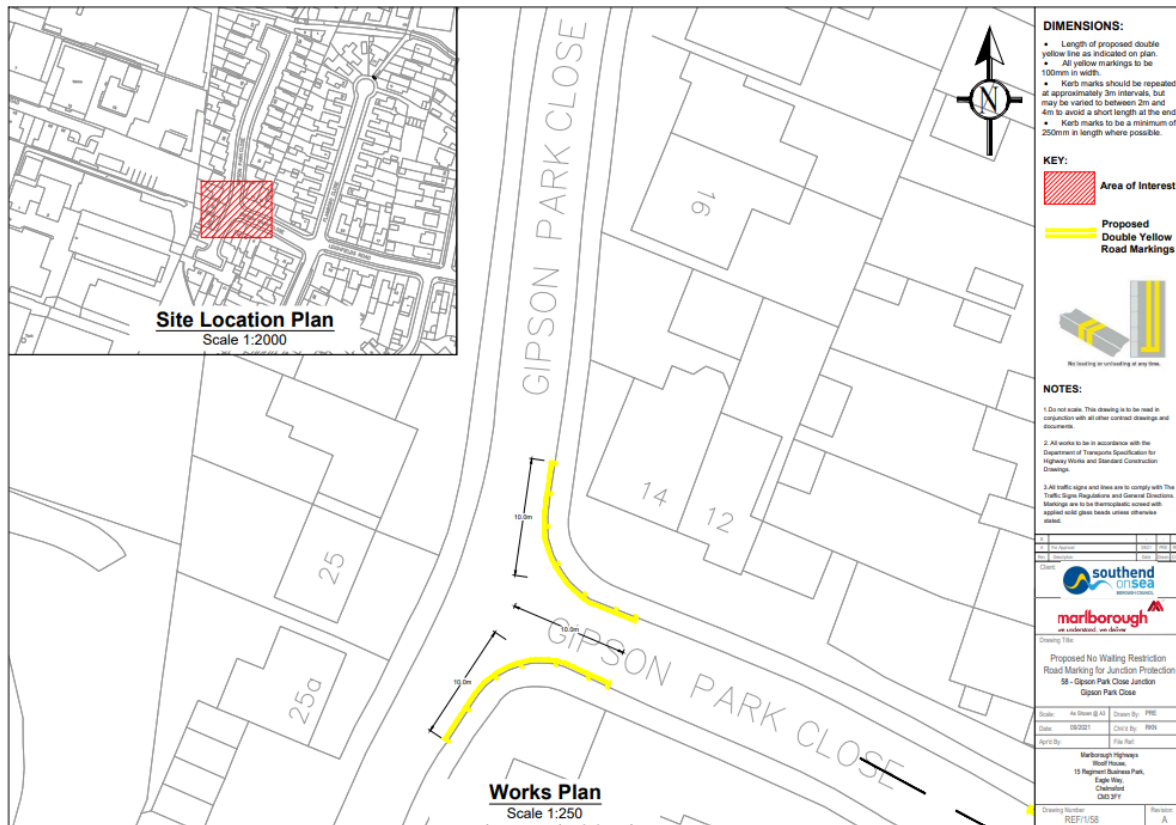
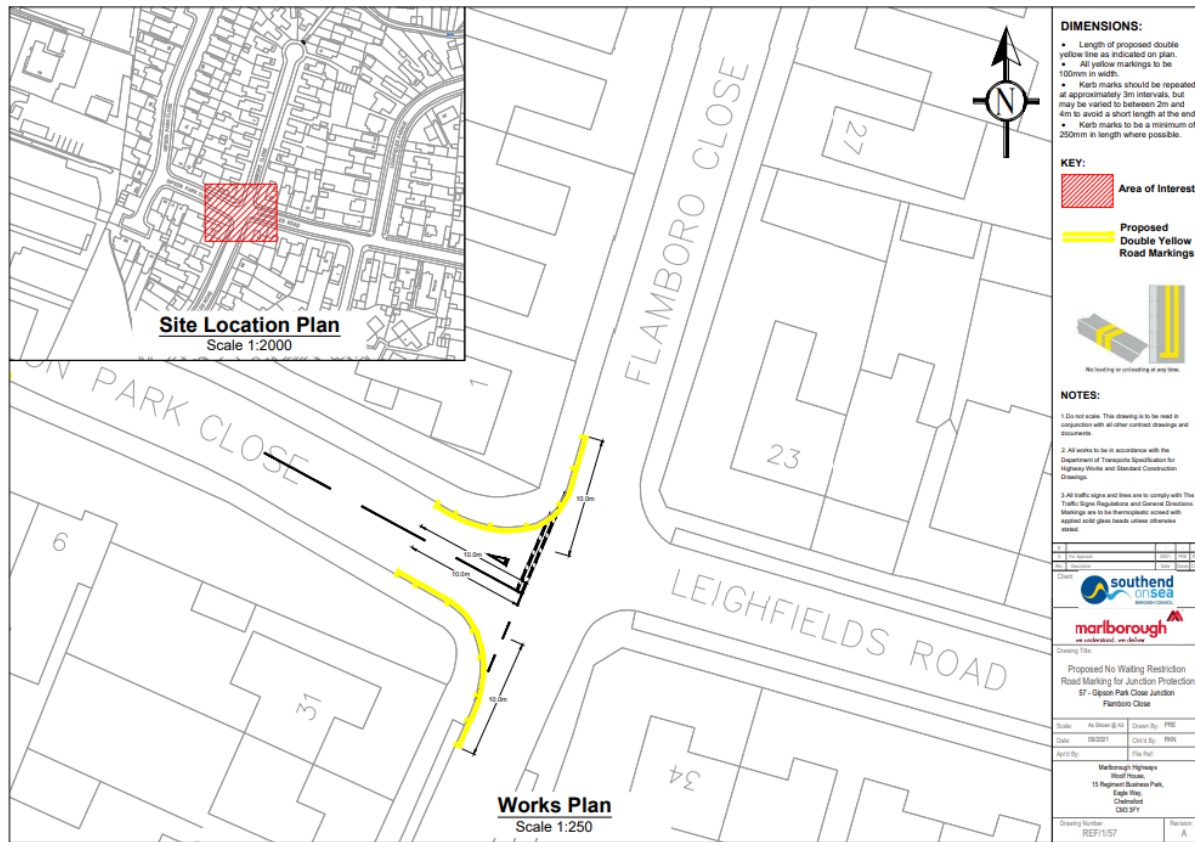

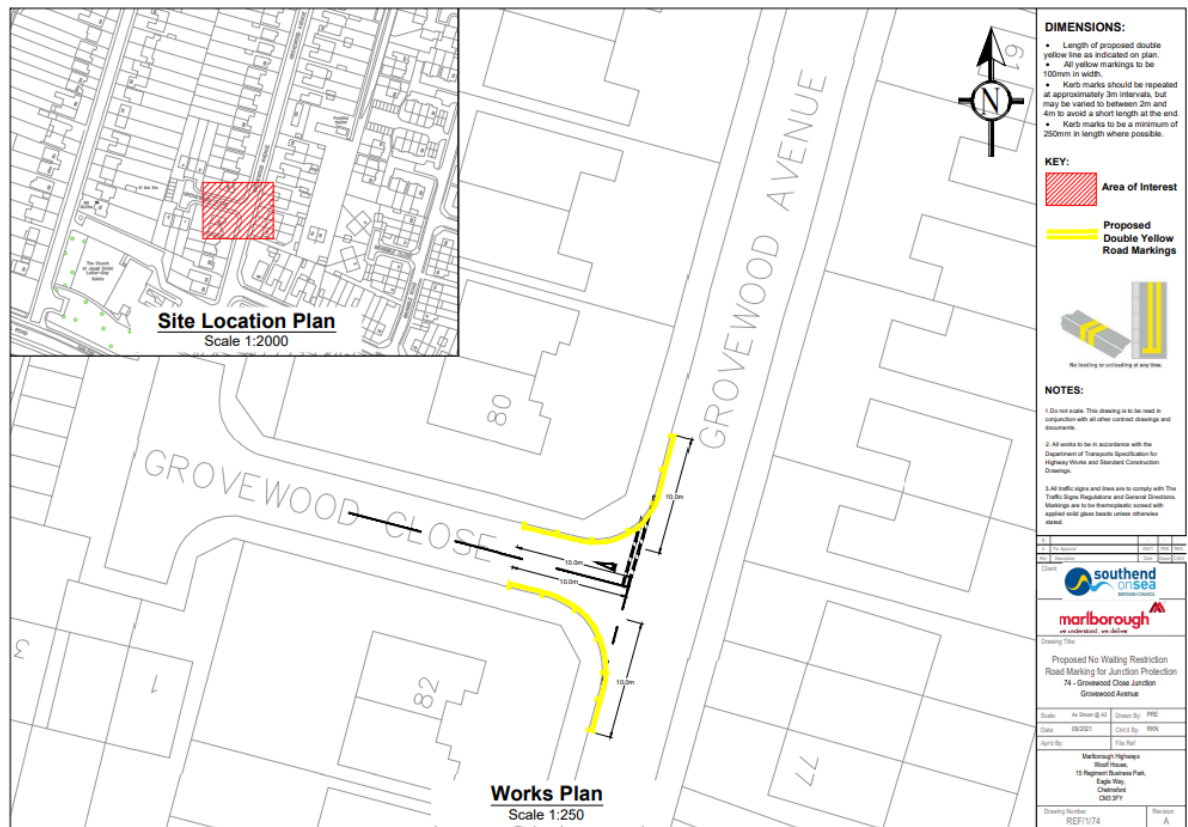
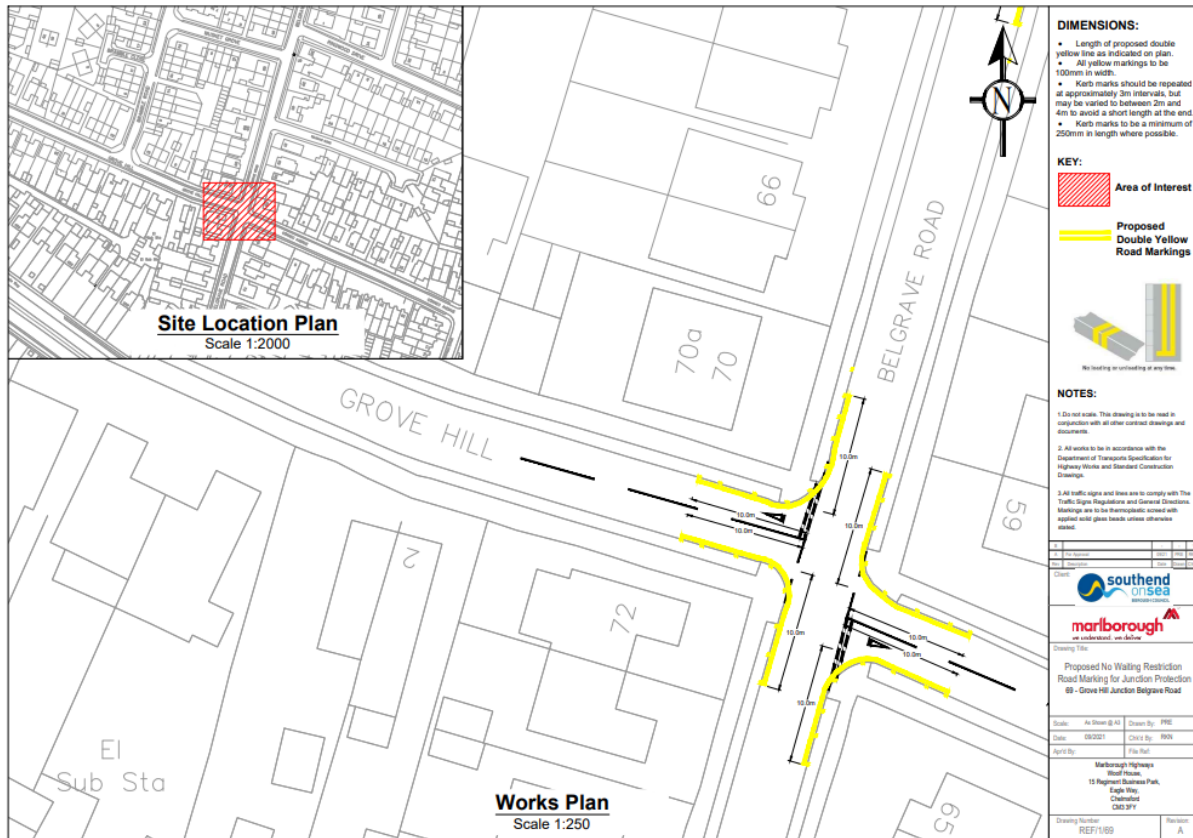

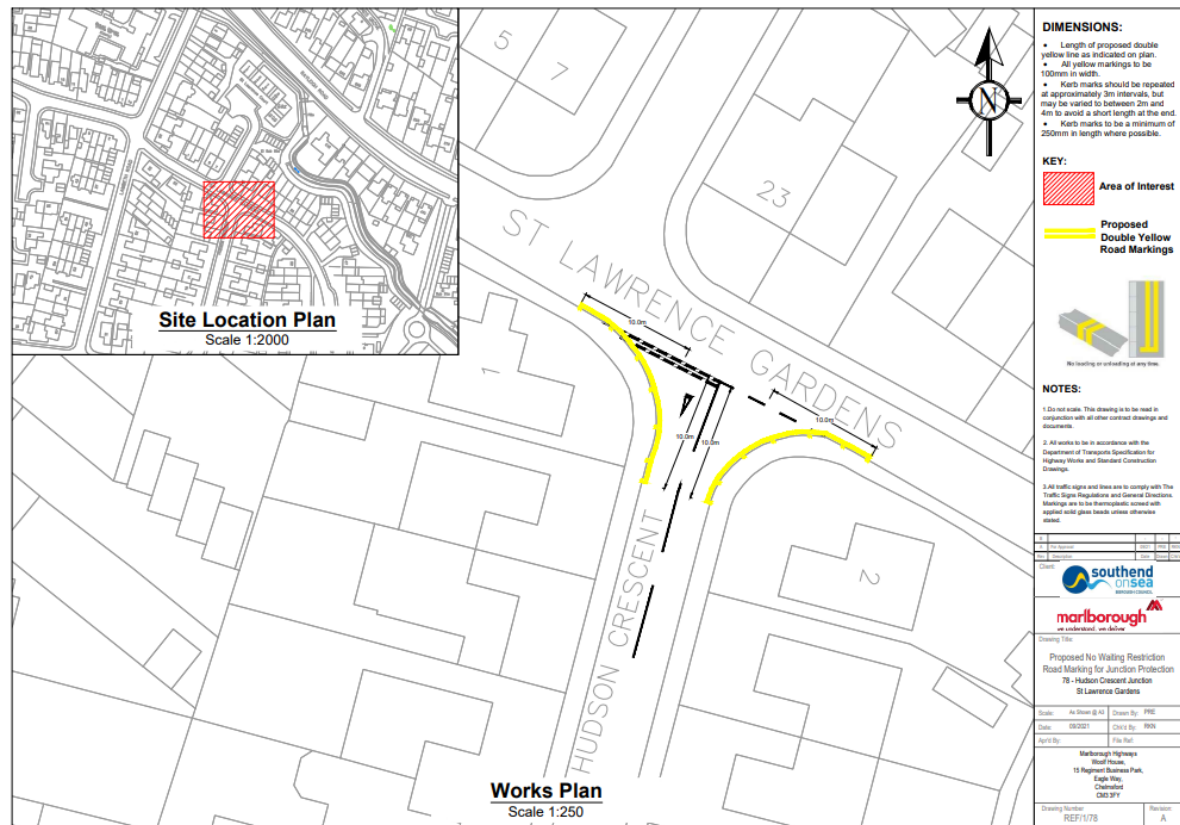
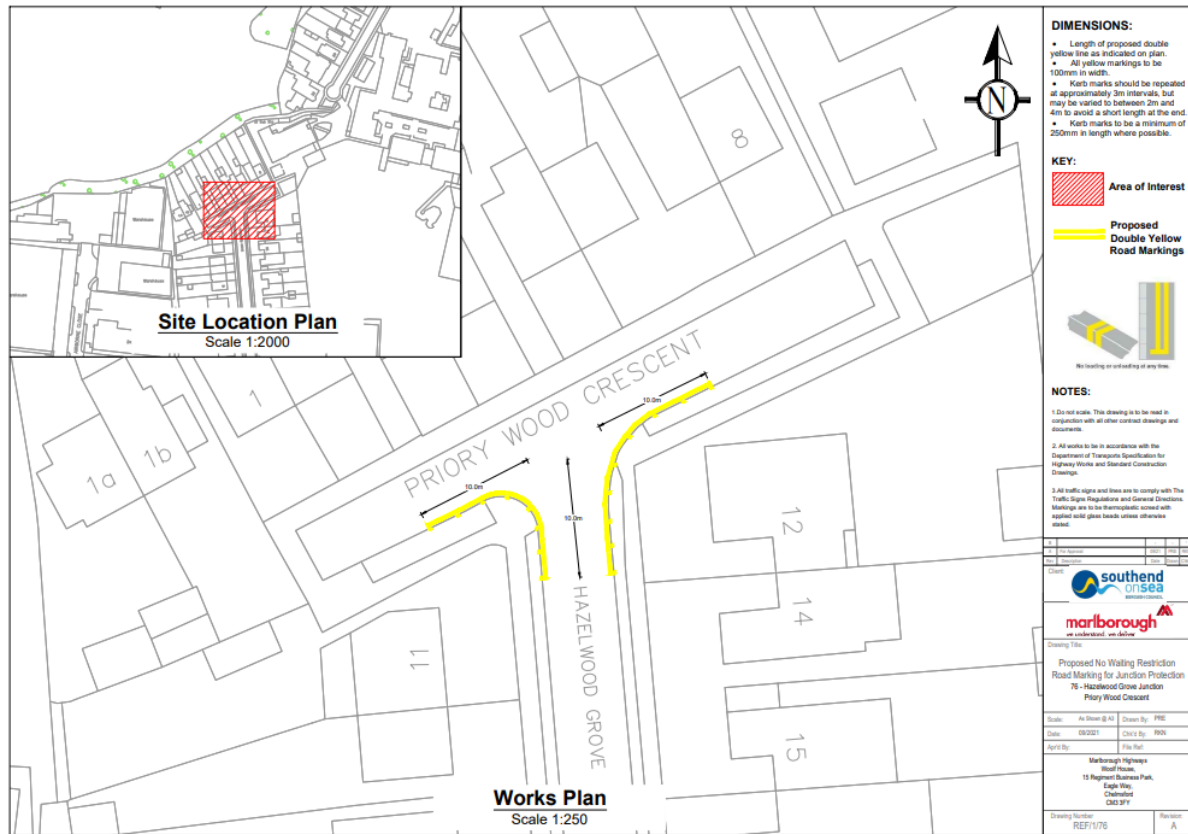

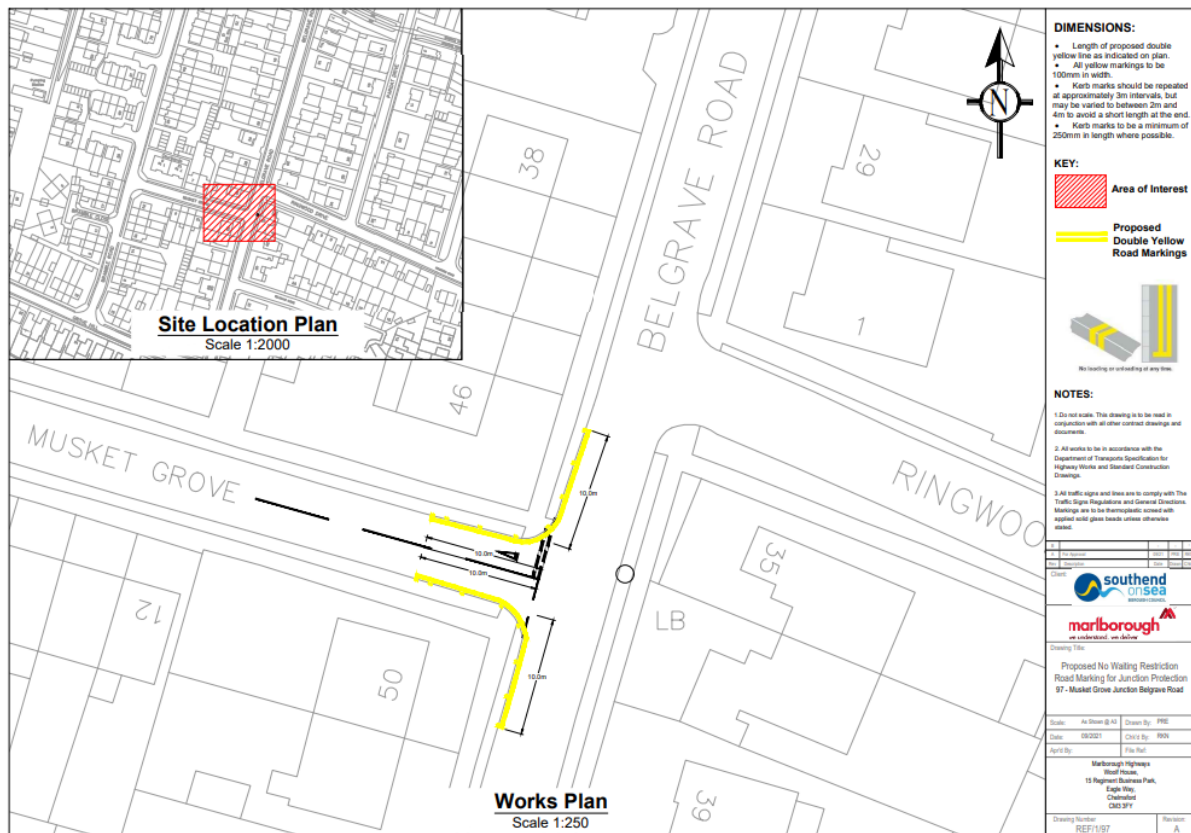
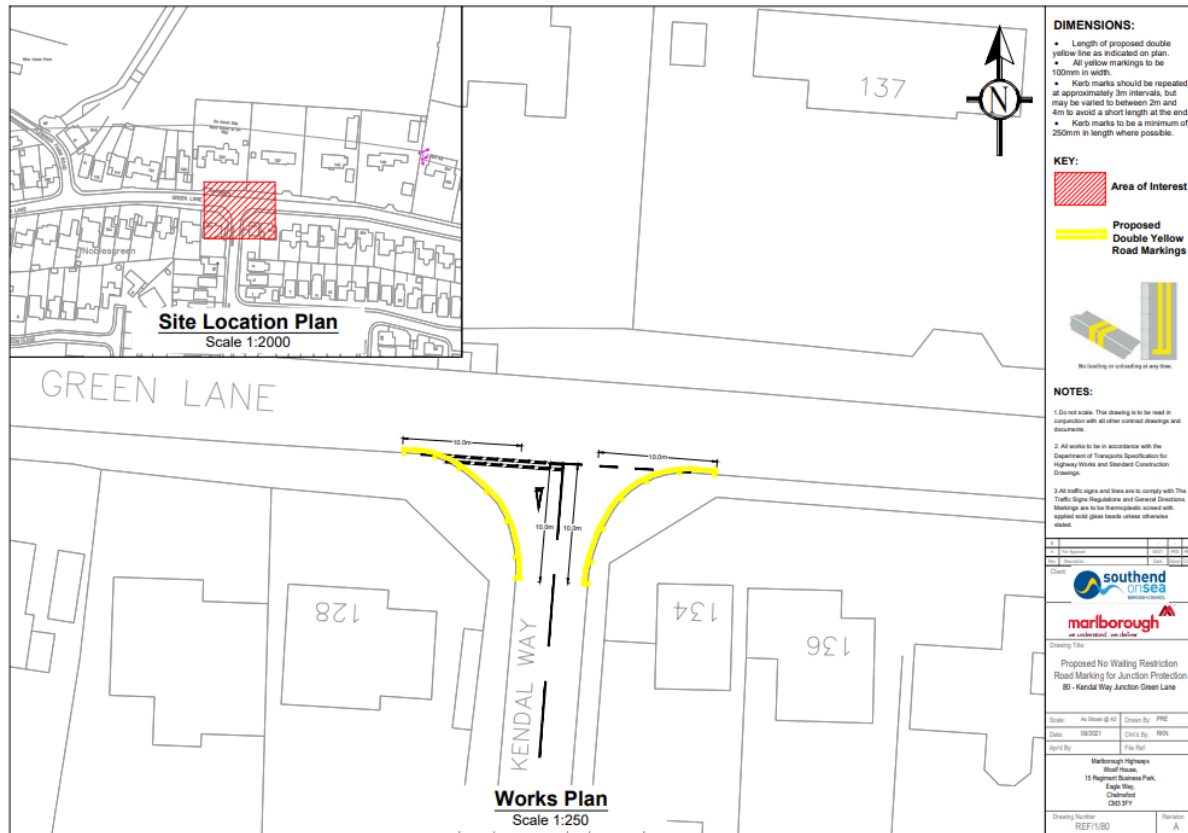

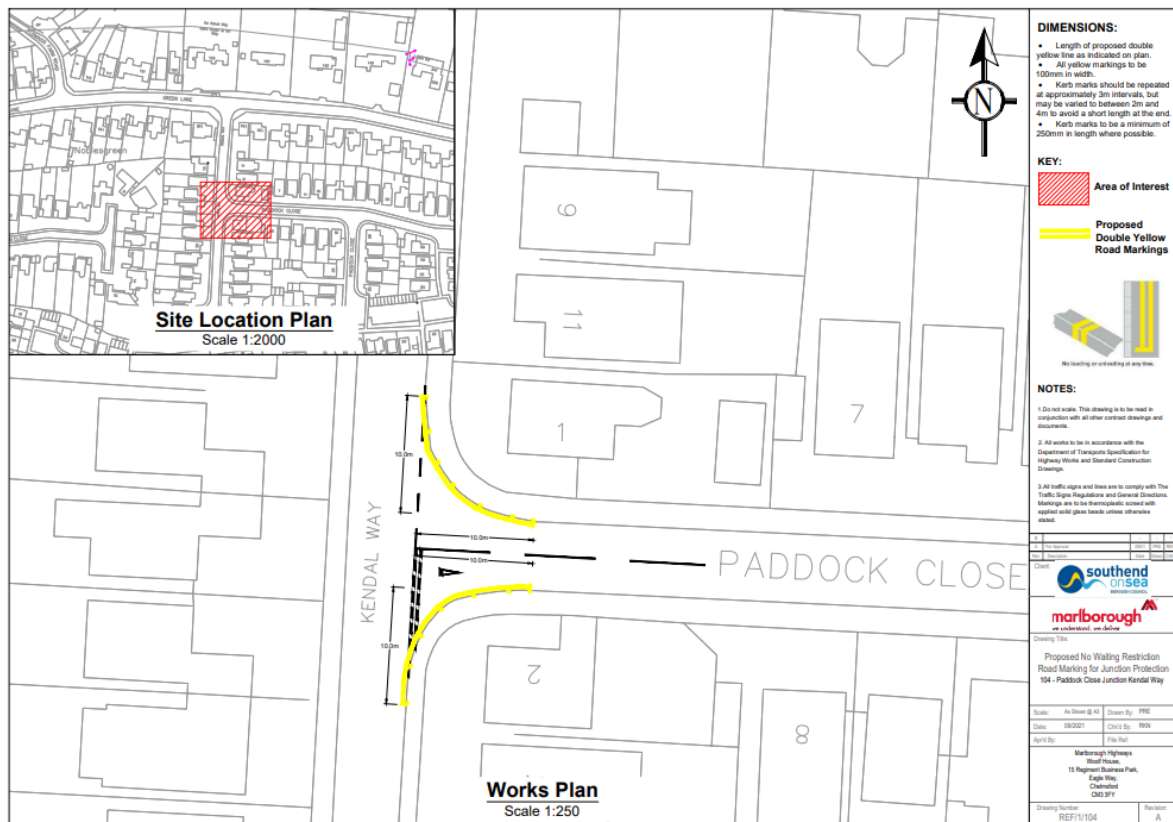
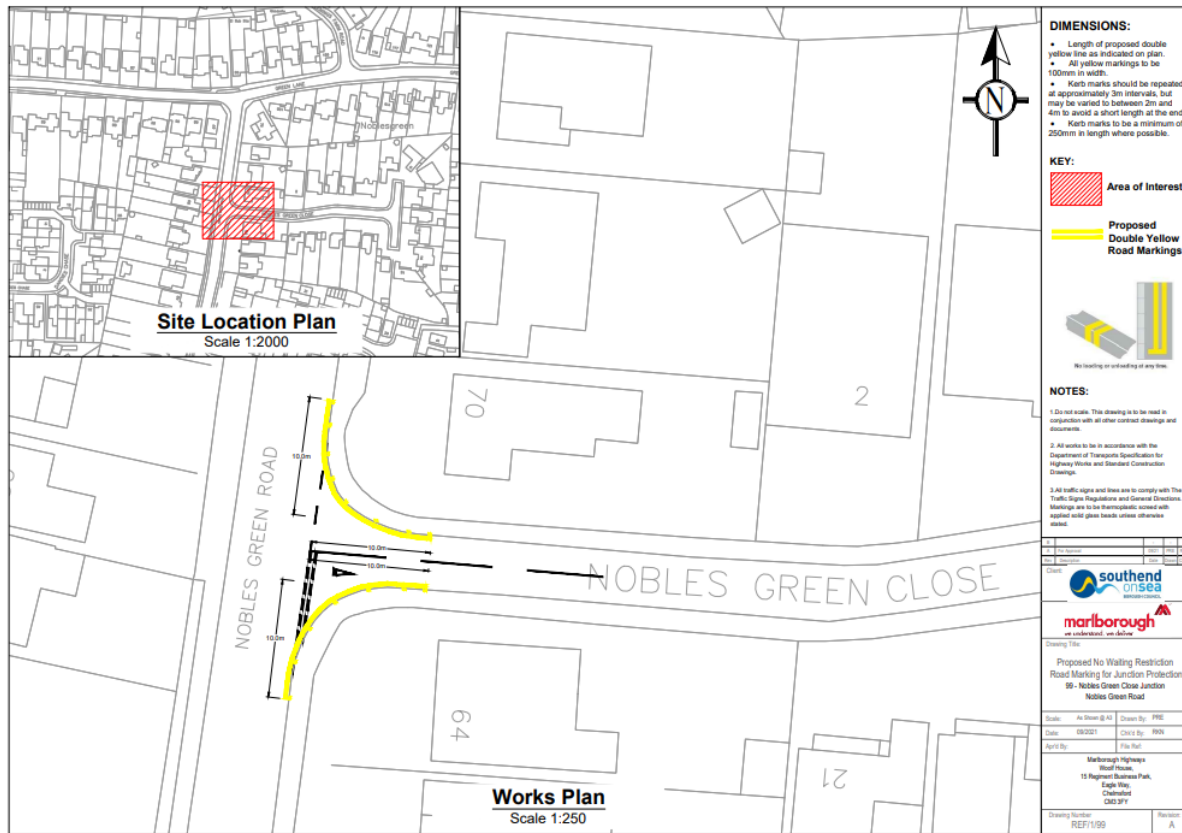

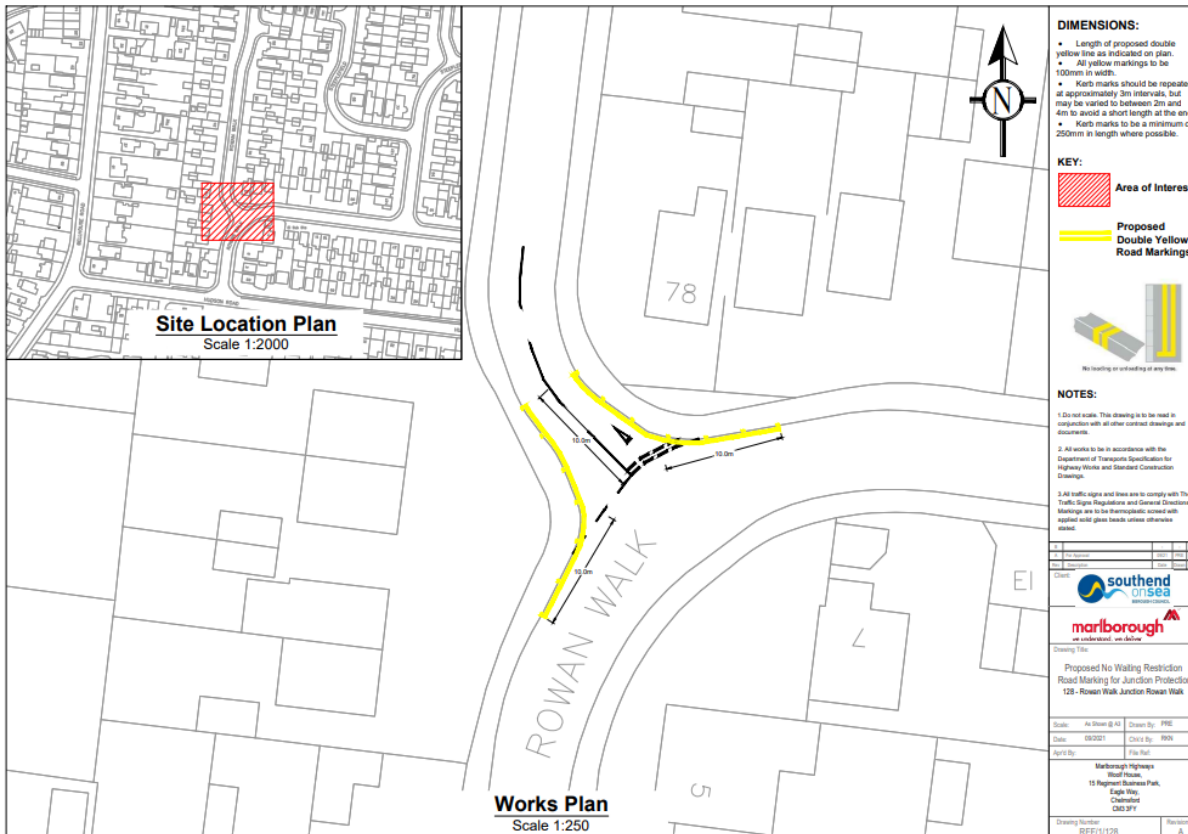
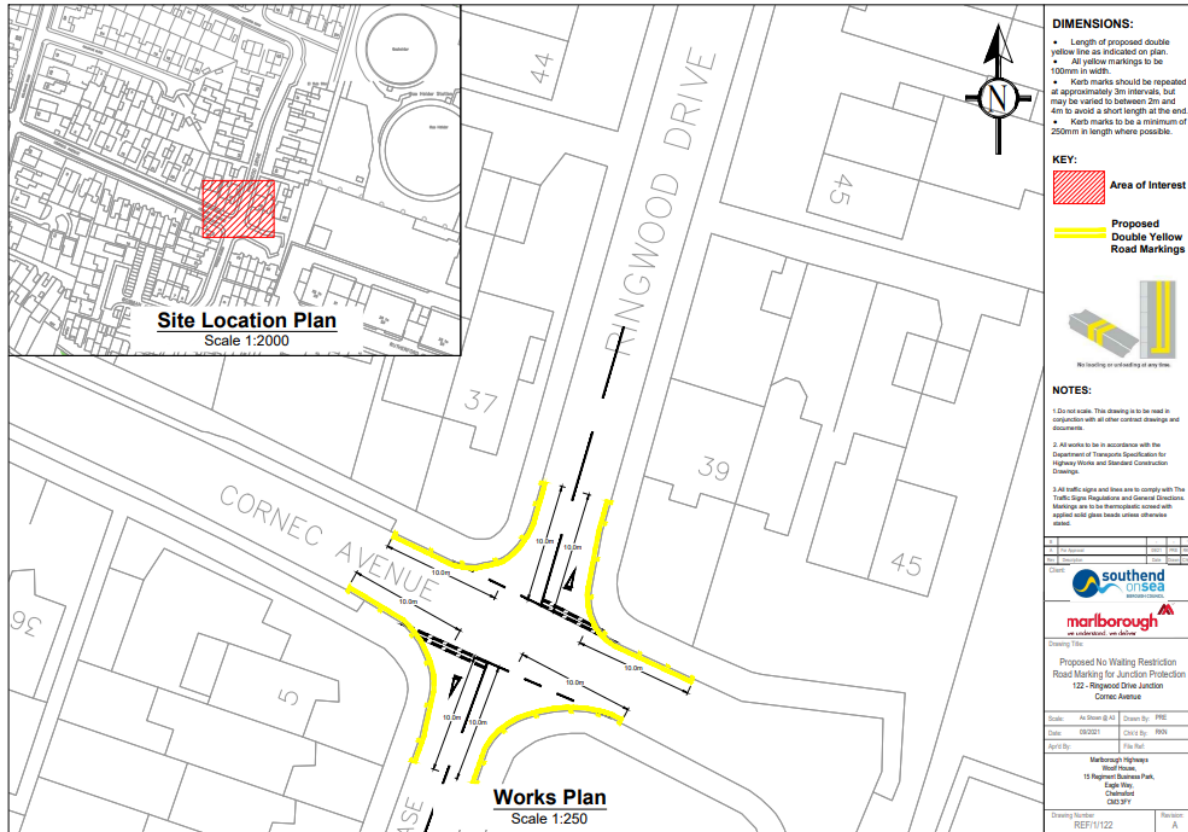

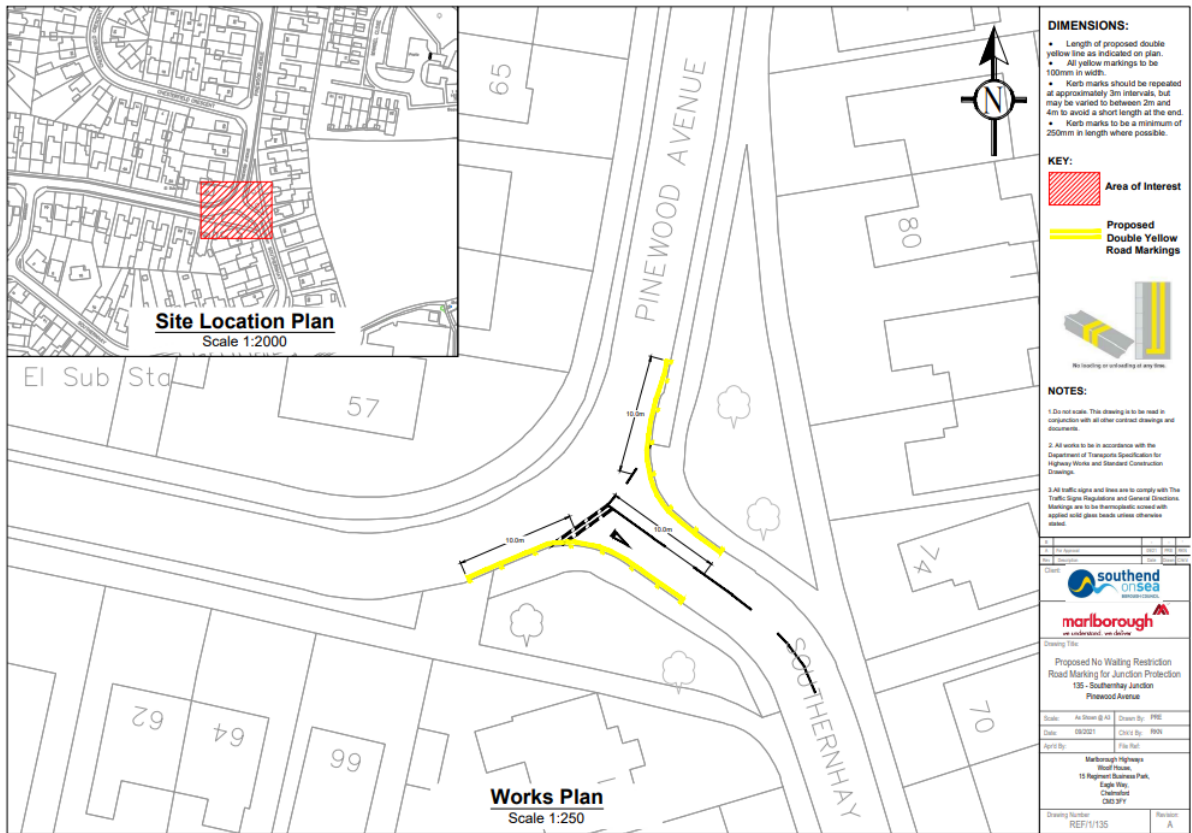
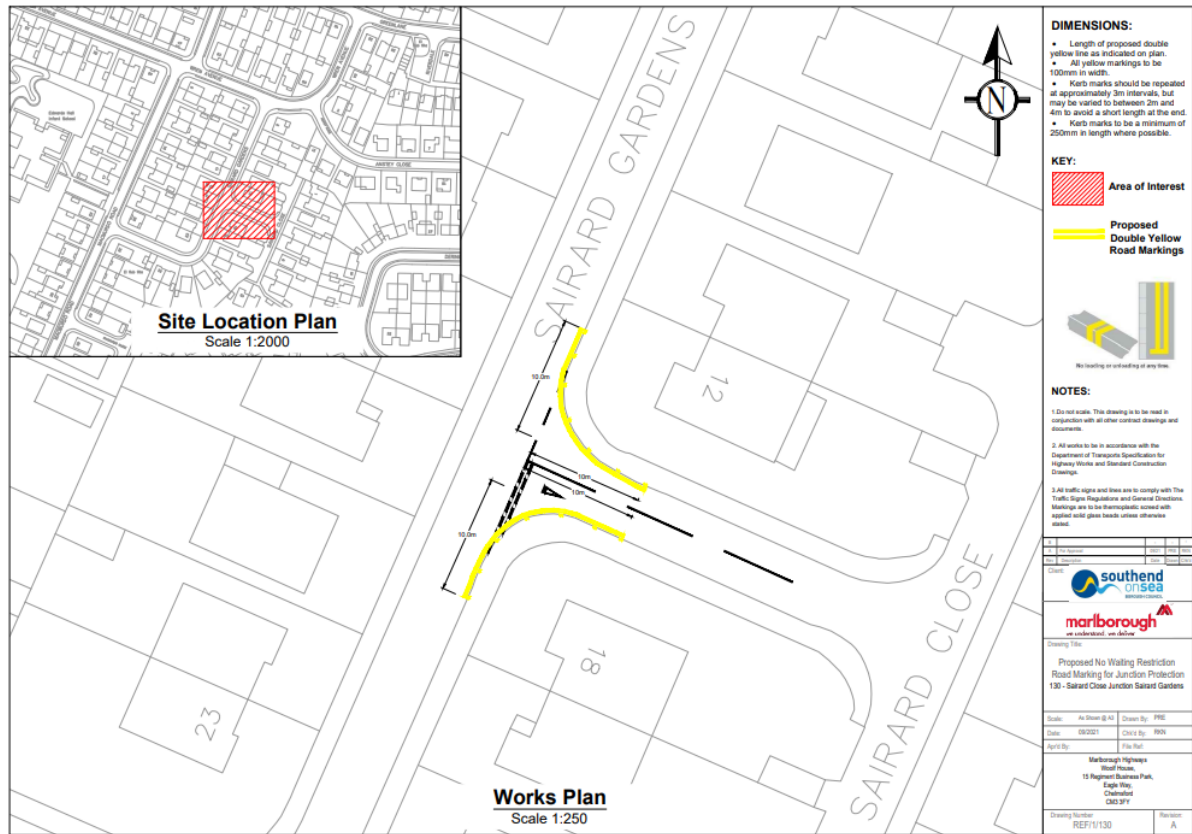

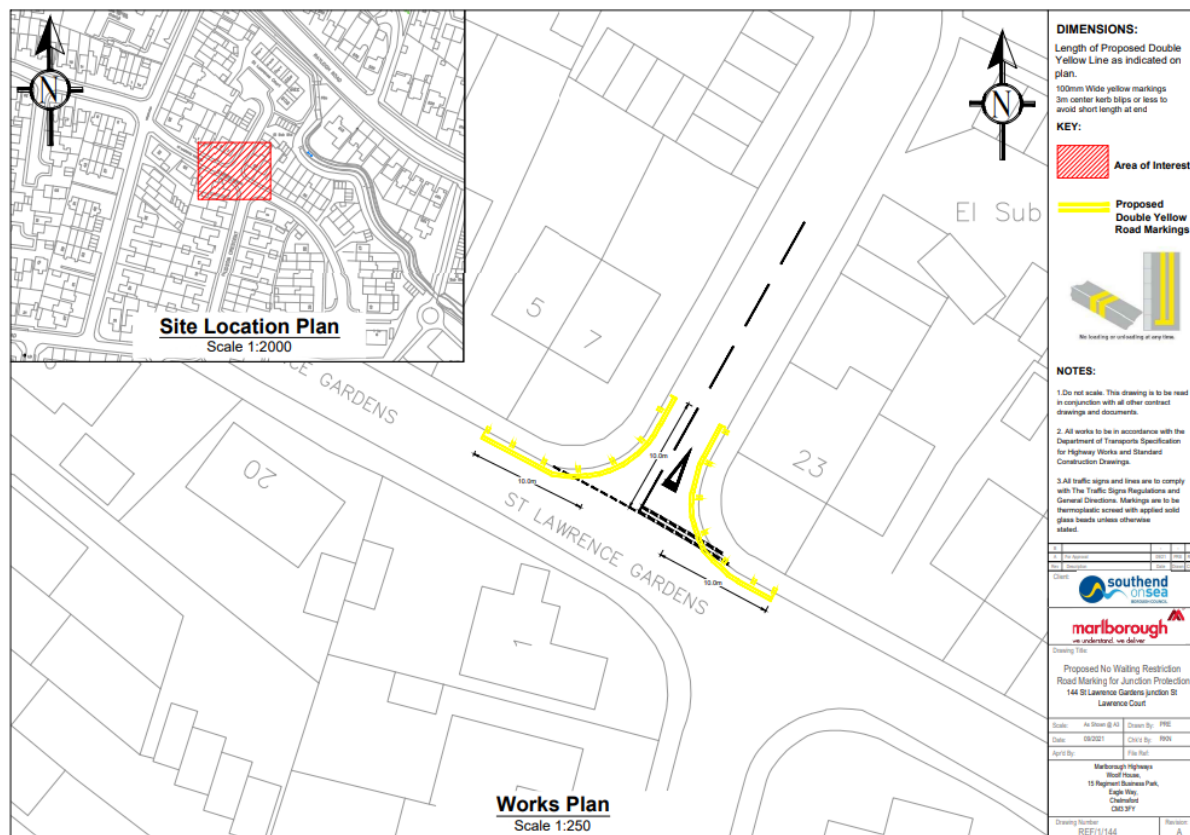

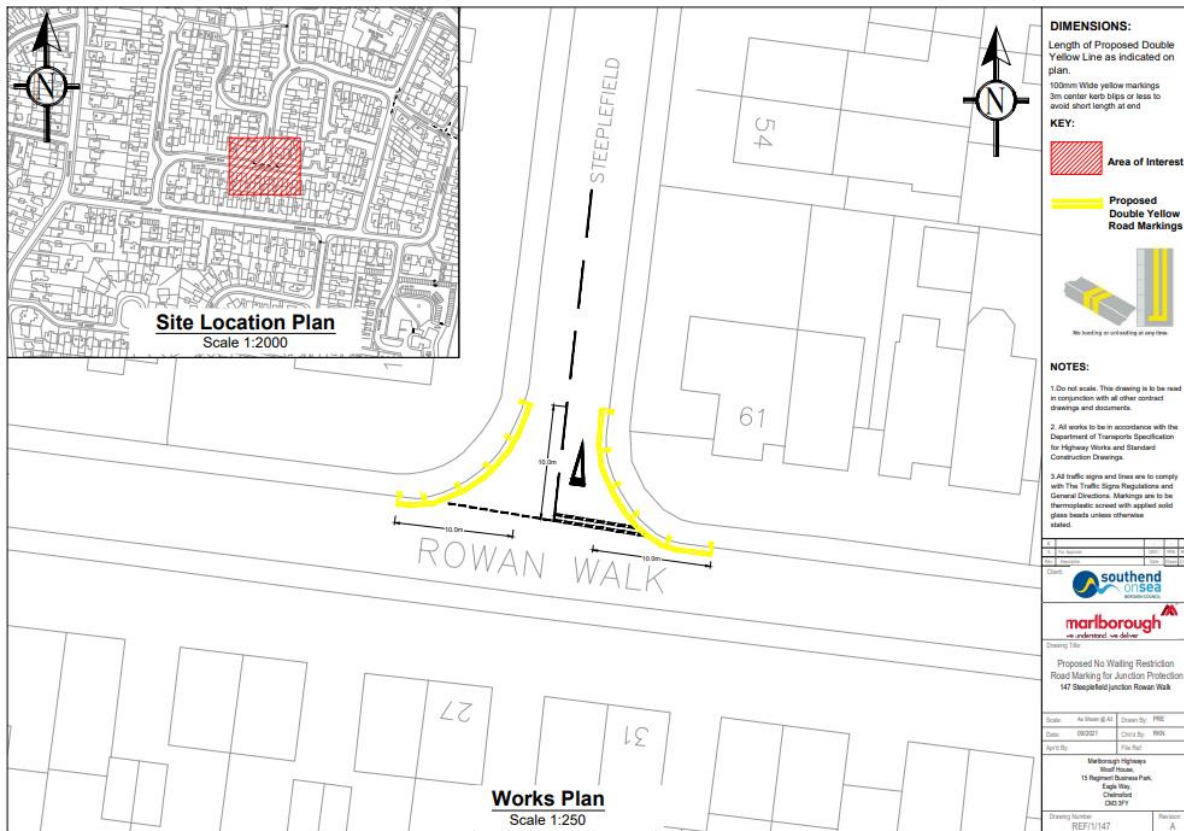
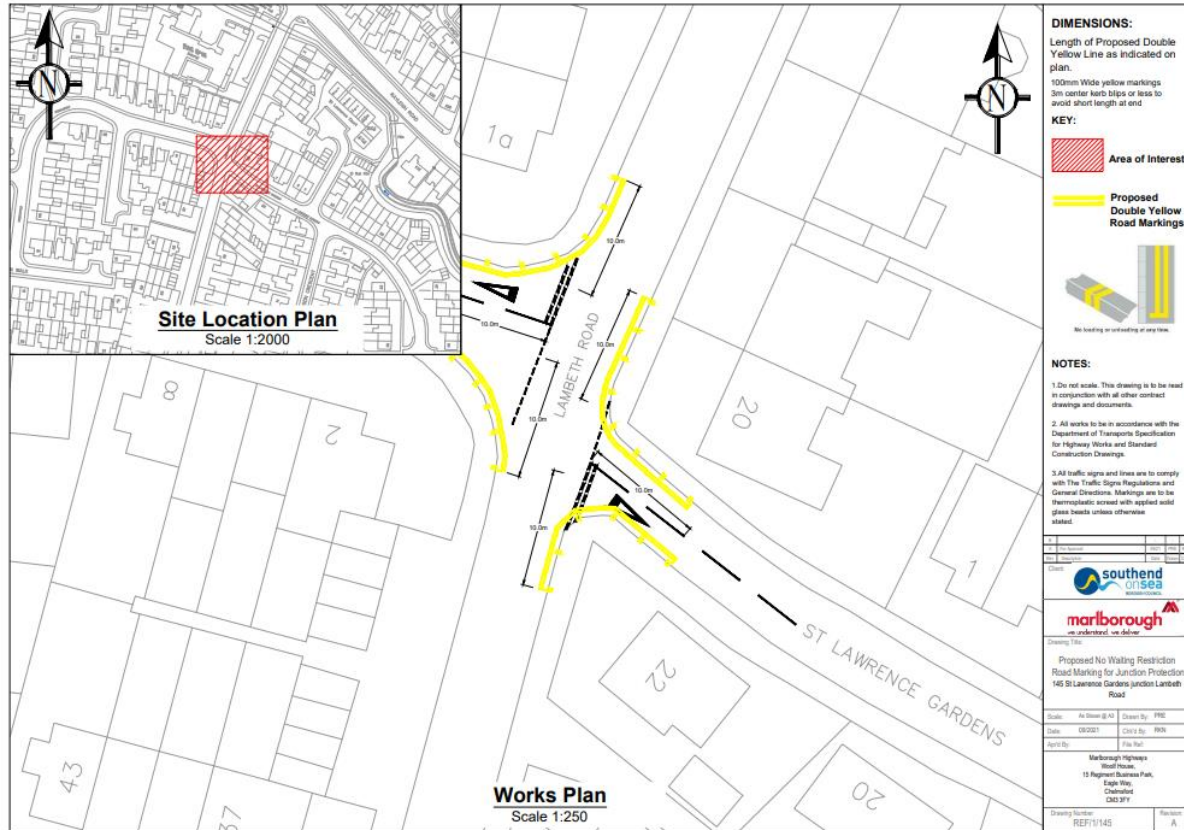

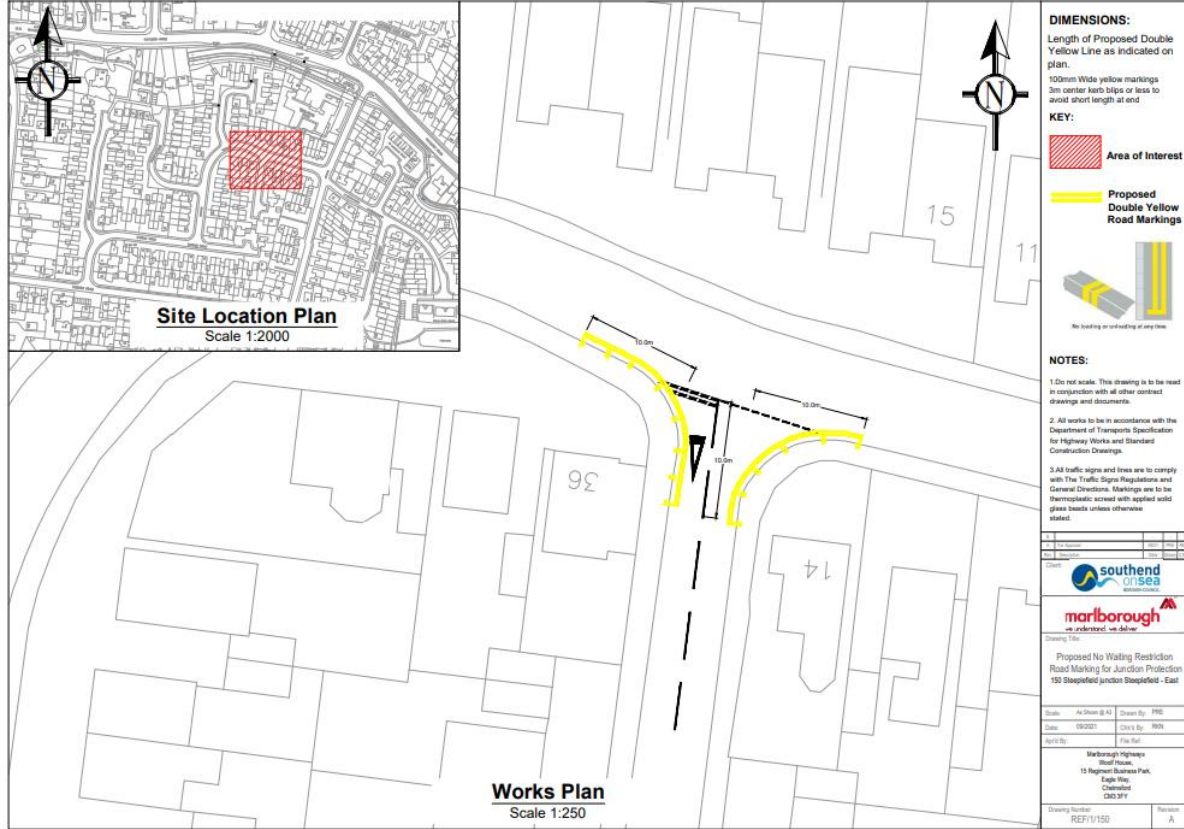

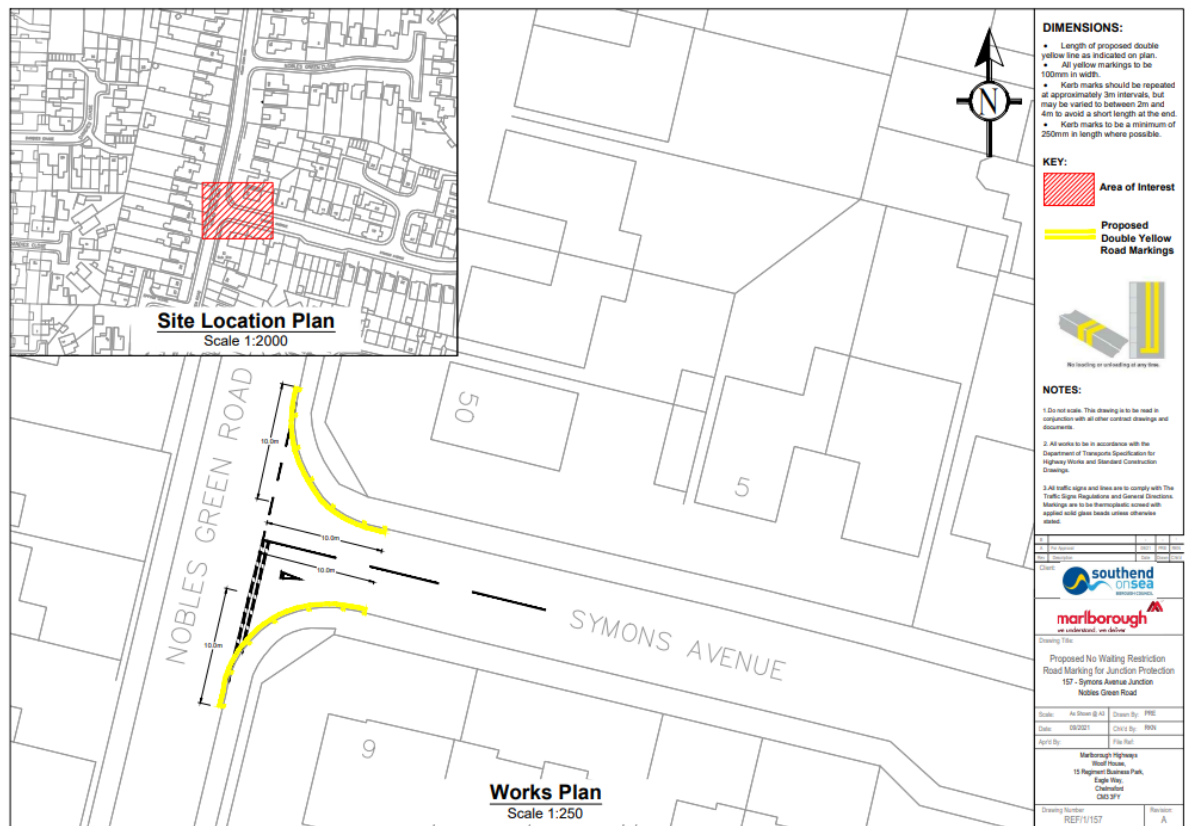
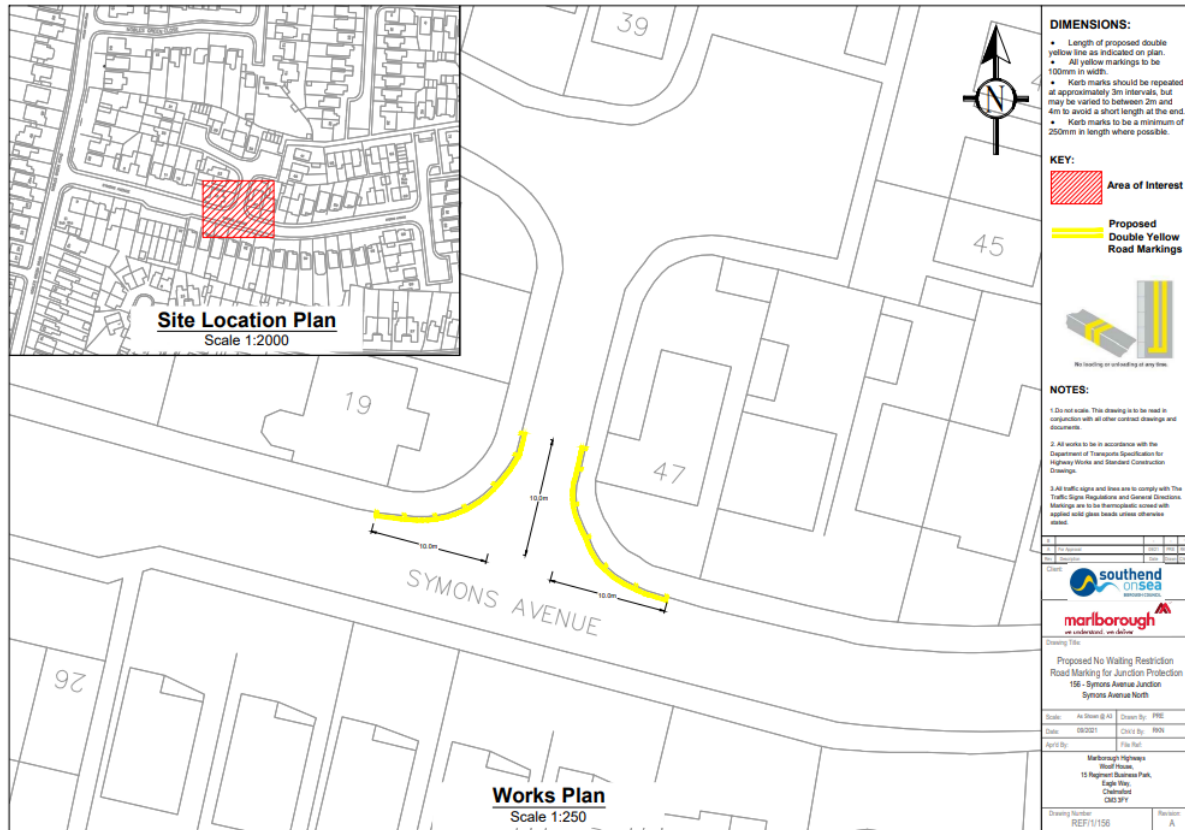

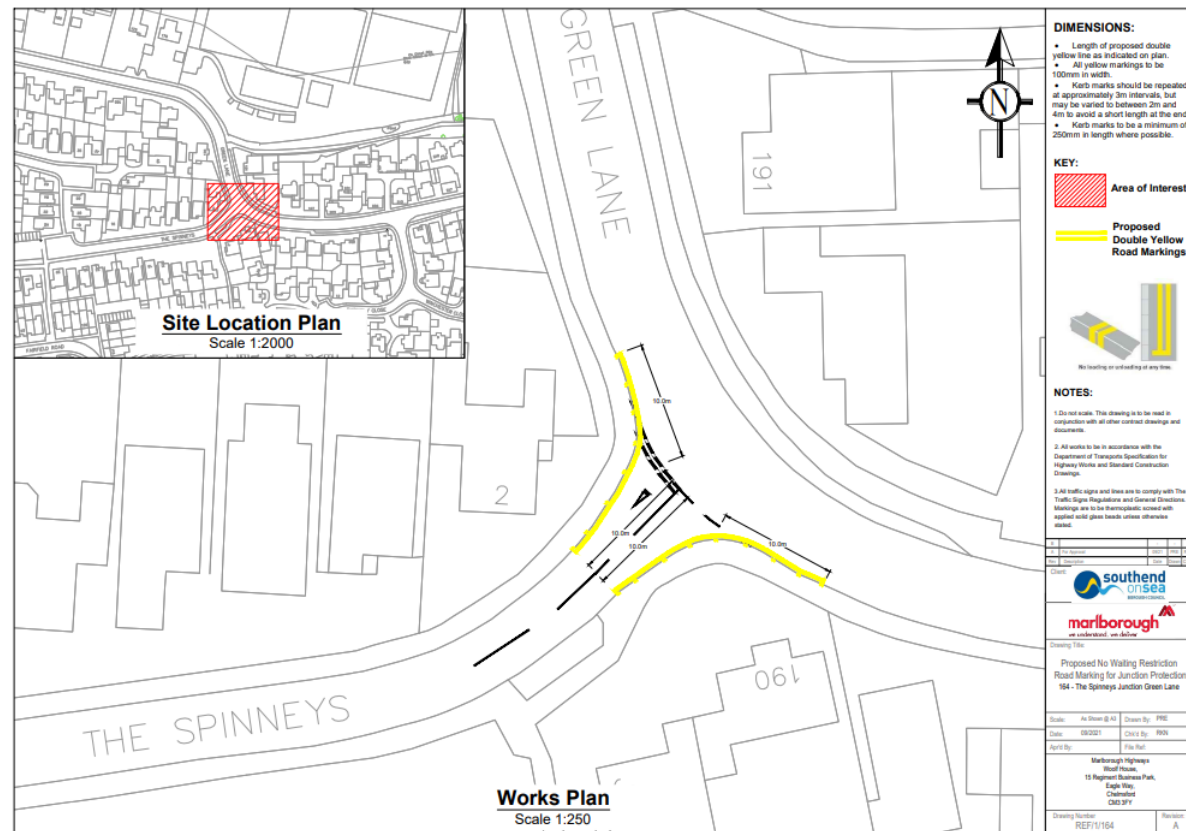
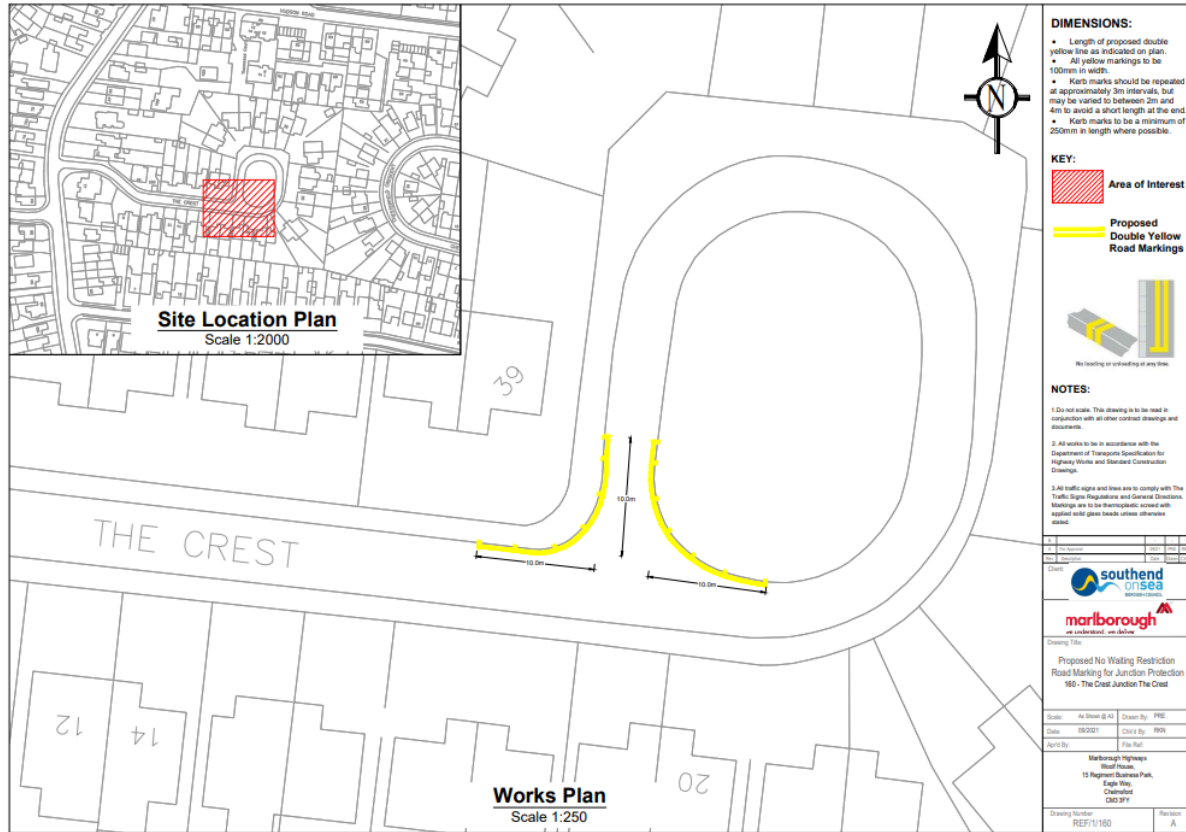

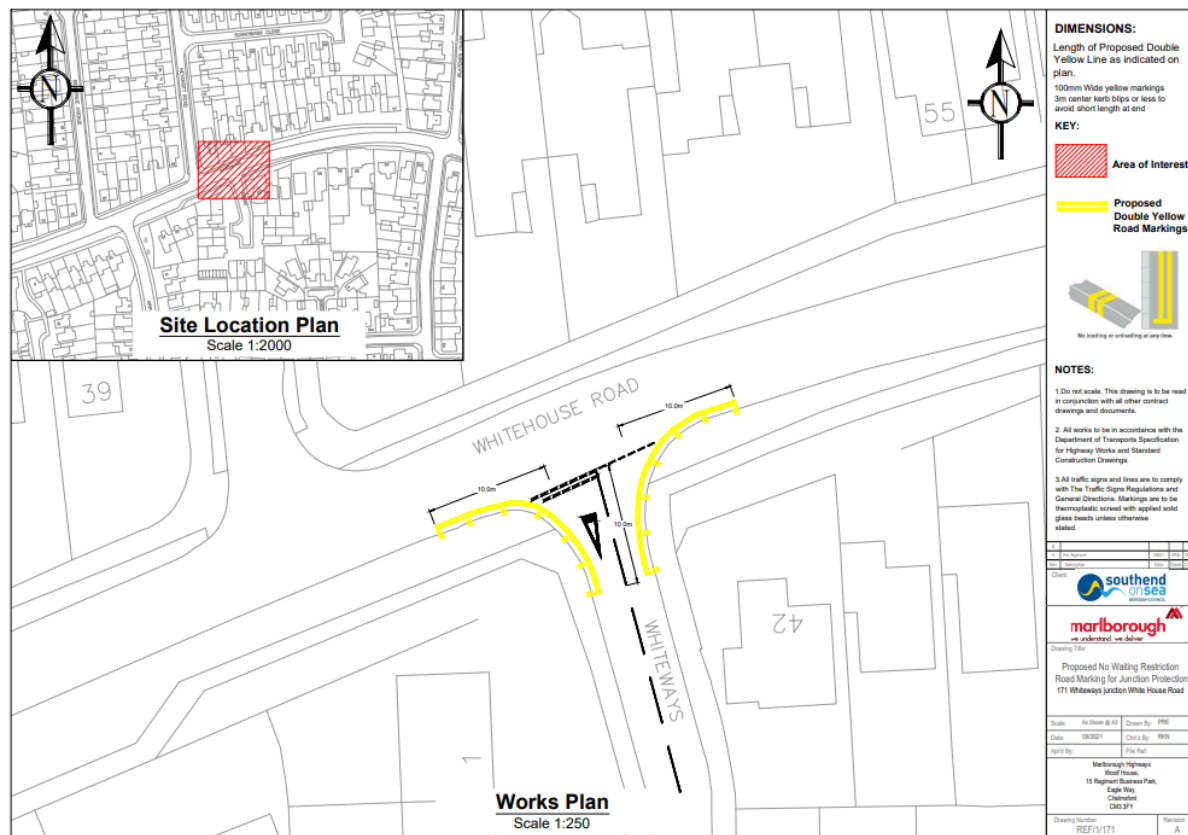
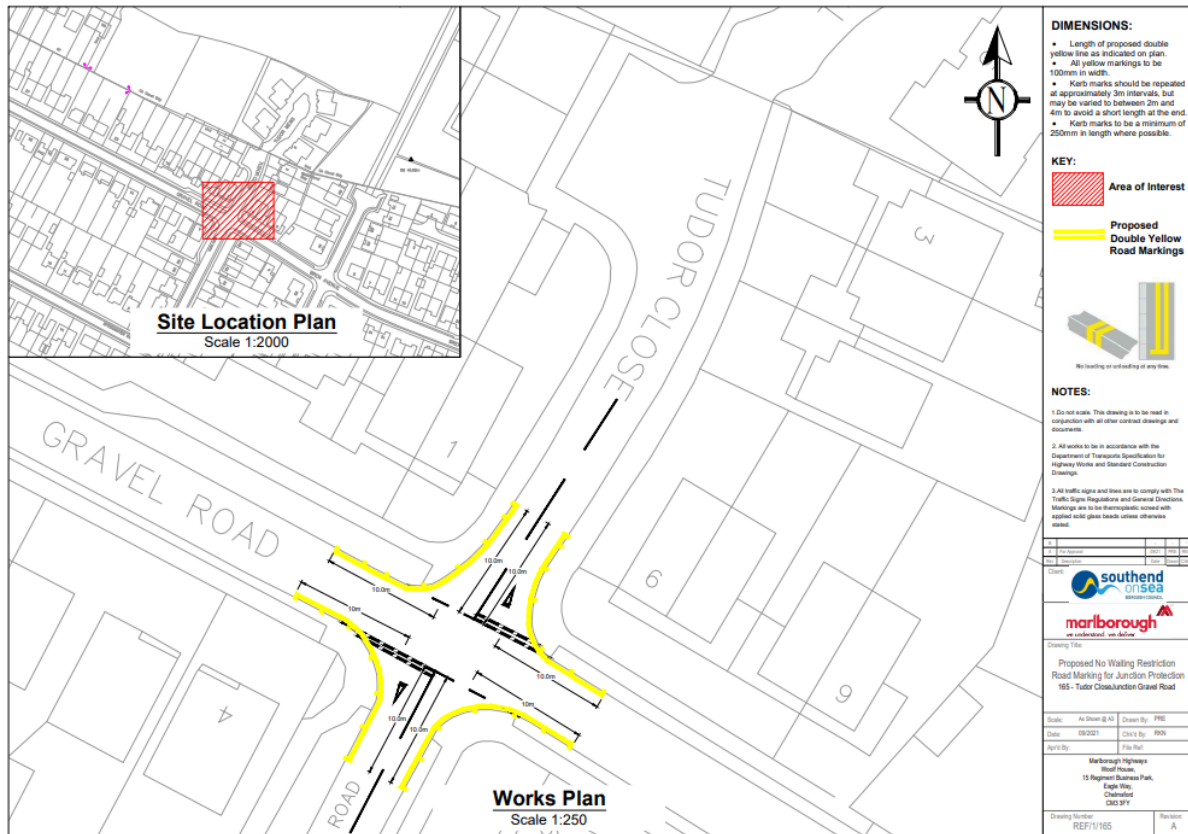

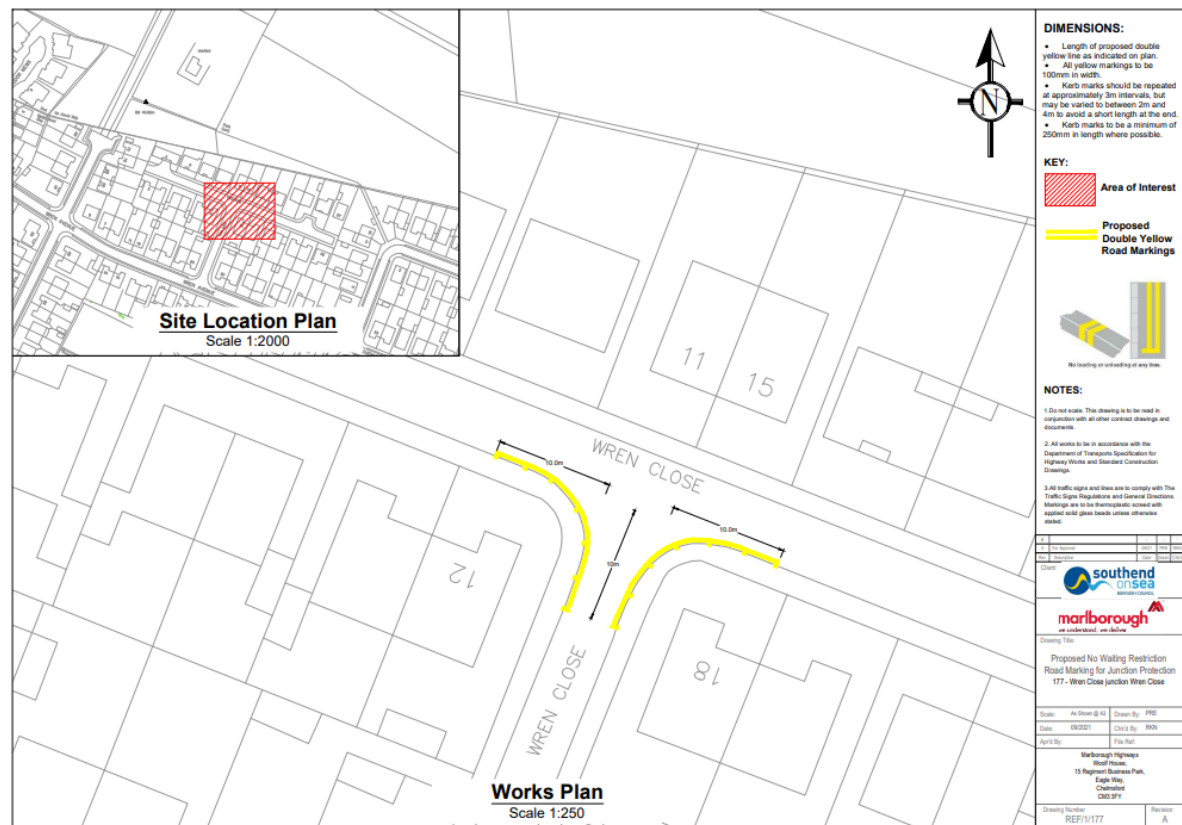
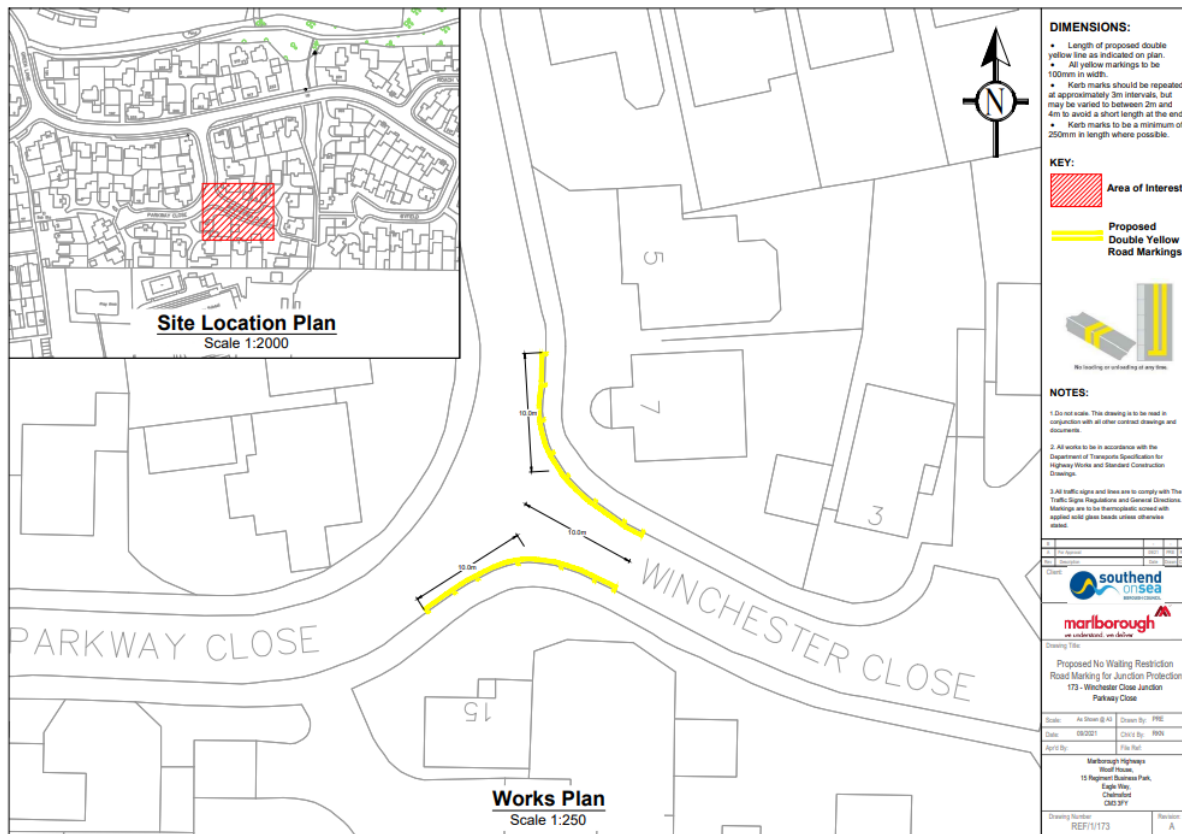

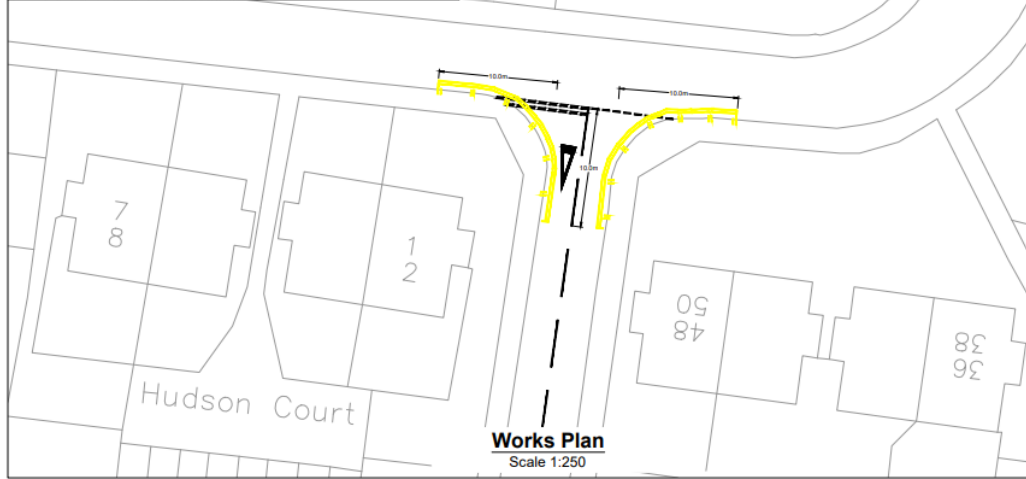
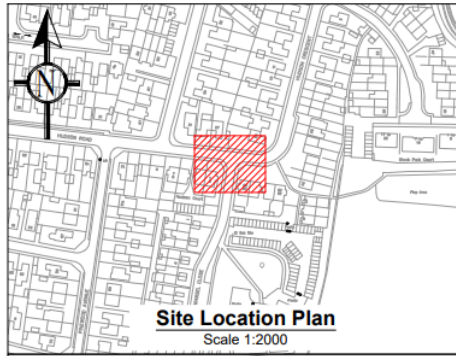



DIMENSIONS:

Length of Proposed Double Yellow Line as indicated on plan.

100mm Wide yellow markings
3m center kerb blips or less to avoid short length at end

KEY:

 Area of Interest

 Proposed Double Yellow Road Markings



NOTES:

- 1 Do not scale. This drawing is to be used in conjunction with all other contract drawings and documents.
- 2 All works to be in accordance with the Department of Transport Specification for Highway Works and Standard Construction Drawings.
- 3 All traffic signs and lines are to comply with The Traffic Signs Regulations and General Directions. Markings are to be thermoplastic screed with applied solid glass beads unless otherwise stated.

1		2		3		4		5		6		7		8		9		10		11		12		13		14		15		16		17		18		19		20		21		22		23		24		25		26		27		28		29		30		31		32		33		34		35		36		37		38		39		40		41		42		43		44		45		46		47		48		49		50		51		52		53		54		55		56		57		58		59		60		61		62		63		64		65		66		67		68		69		70		71		72		73		74		75		76		77		78		79		80		81		82		83		84		85		86		87		88		89		90		91		92		93		94		95		96		97		98		99		100		101		102		103		104		105		106		107		108		109		110		111		112		113		114		115		116		117		118		119		120		121		122		123		124		125		126		127		128		129		130		131		132		133		134		135		136		137		138		139		140		141		142		143		144		145		146		147		148		149		150		151		152		153		154		155		156		157		158		159		160		161		162		163		164		165		166		167		168		169		170		171		172		173		174		175		176		177		178		179		180		181		182		183		184		185		186		187		188		189		190		191		192		193		194		195		196		197		198		199		200		201		202		203		204		205		206		207		208		209		210		211		212		213		214		215		216		217		218		219		220		221		222		223		224		225		226		227		228		229		230		231		232		233		234		235		236		237		238		239		240		241		242		243		244		245		246		247		248		249		250		251		252		253		254		255		256		257		258		259		260		261		262		263		264		265		266		267		268		269		270		271		272		273		274		275		276		277		278		279		280		281		282		283		284		285		286		287		288		289		290		291		292		293		294		295		296		297		298		299		300		301		302		303		304		305		306		307		308		309		310		311		312		313		314		315		316		317		318		319		320		321		322		323		324		325		326		327		328		329		330		331		332		333		334		335		336		337		338		339		340		341		342		343		344		345		346		347		348		349		350		351		352		353		354		355		356		357		358		359		360		361		362		363		364		365		366		367		368		369		370		371		372		373		374		375		376		377		378		379		380		381		382		383		384		385		386		387		388		389		390		391		392		393		394		395		396		397		398		399		400		401		402		403		404		405		406		407		408		409		410		411		412		413		414		415		416		417		418		419		420		421		422		423		424		425		426		427		428		429		430		431		432		433		434		435		436		437		438		439		440		441		442		443		444		445		446		447		448		449		450		451		452		453		454		455		456		457		458		459		460		461		462		463		464		465		466		467		468		469		470		471		472		473		474		475		476		477		478		479		480		481		482		483		484		485		486		487		488		489		490		491		492		493		494		495		496		497		498		499		500		501		502		503		504		505		506		507		508		509		510		511		512		513		514		515		516		517		518		519		520		521		522		523		524		525		526		527		528		529		530		531		532		533		534		535		536		537		538		539		540		541		542		543		544		545		546		547		548		549		550		551		552		553		554		555		556		557		558		559		560		561		562		563		564		565		566		567		568		569		570		571		572		573		574		575		576		577		578		579		580		581		582		583		584		585		586		587		588		589		590		591		592		593		594		595		596		597		598		599		600		601		602		603		604		605		606		607		608		609		610		611		612		613		614		615		616		617		618		619		620		621		622		623		624		625		626		627		628		629		630		631		632		633		634		635		636		637		638		639		640		641		642		643		644		645		646		647		648		649		650		651		652		653		654		655		656		657		658		659		660		661		662		663		664		665		666		667		668		669		670		671		672		673		674		675		676		677		678		679		680		681		682		683		684		685		686		687		688		689		690		691		692		693		694		695		696		697		698		699		700		701		702		703		704		705		706		707		708		709		710		711		712		713		714		715		716		717		718		719		720		721		722		723		724		725		726		727		728		729		730		731		732		733		734		735		736		737		738		739		740		741		742		743		744		745		746		747		748		749		750		751		752		753		754		755		756		757		758		759		760		761		762		763		764		765		766		767		768		769		770		771		772		773		774		775		776		777		778		779		780		781		782		783		784		785		786		787		788		789		790		791		792		793		794		795		796		797		798		799		800		801		802		803		804		805		806		807		808		809		810		811		812		813		814		815		816		817		818		819		820		821		822		823		824		825		826		827		828		829		830		831		832		833		834		835		836		837		838		839		840		841		842		843		844		845		846		847		848		849		850		851		852		853		854		855		856		857		858		859		860		861		862		863		864		865		866		867		868		869		870		871		872		873		874		875		876		877		878		879		880		881		882		883		884		885		886		887		888		889		890		891		892		893		894		895		896		897		898		899		900		901		902		903		904		905		906		907		908		909		910		911		912		913		914		915		916		917		918		919		920		921		922		923		924		925		926		927		928		929		930		931		932		933		934		935		936		937		938		939		940		941		942		943		944		945		946		947		948		949		950		951		952		953		954		955		956		957		958		959		960		961		962		963		964		965		966		967		968		969		970		971		972		973		974		975		976		977		978		979		980		981		982		983		984		985		986		987		988		989		990		991		992		993		994		995		996		997		998		999		1000		1001		1002		1003		1004		1005		1006		1007		1008		1009		1010		1011		1012		1013		1014		1015		1016		1017		1018		1019		1020		1021		1022		1023		1024		1025		1026		1027		1028		1029		1030		1031		1032		1033		1034		1035		1036		1037		1038		1039		1040		1041		1042		1043		1044		1045		1046		1047		1048		1049		1050		1051		1052		1053		1054		1055		1056		1057		1058		1059		1060		1061		1062		1063		1064		1065		1066		1067		1068		1069		1070		1071		1072		1073		1074		1075		1076		1077		1078		1079		1080		1081		1082		1083		1084		1085		1086		1087		1088		1089		1090		1091		1092		1093		1094		1095		1096		1097		1098		1099		1100		1101		1102		1103		1104		1105		1106		1107		1108		1109		1110		1111		1112		1113		1114		1115		1116		1117		1118		1119		1120		1121		1122		1123		1124	
---	--	---	--	---	--	---	--	---	--	---	--	---	--	---	--	---	--	----	--	----	--	----	--	----	--	----	--	----	--	----	--	----	--	----	--	----	--	----	--	----	--	----	--	----	--	----	--	----	--	----	--	----	--	----	--	----	--	----	--	----	--	----	--	----	--	----	--	----	--	----	--	----	--	----	--	----	--	----	--	----	--	----	--	----	--	----	--	----	--	----	--	----	--	----	--	----	--	----	--	----	--	----	--	----	--	----	--	----	--	----	--	----	--	----	--	----	--	----	--	----	--	----	--	----	--	----	--	----	--	----	--	----	--	----	--	----	--	----	--	----	--	----	--	----	--	----	--	----	--	----	--	----	--	----	--	----	--	----	--	----	--	----	--	----	--	----	--	----	--	----	--	----	--	----	--	----	--	----	--	----	--	----	--	----	--	----	--	----	--	----	--	----	--	----	--	----	--	-----	--	-----	--	-----	--	-----	--	-----	--	-----	--	-----	--	-----	--	-----	--	-----	--	-----	--	-----	--	-----	--	-----	--	-----	--	-----	--	-----	--	-----	--	-----	--	-----	--	-----	--	-----	--	-----	--	-----	--	-----	--	-----	--	-----	--	-----	--	-----	--	-----	--	-----	--	-----	--	-----	--	-----	--	-----	--	-----	--	-----	--	-----	--	-----	--	-----	--	-----	--	-----	--	-----	--	-----	--	-----	--	-----	--	-----	--	-----	--	-----	--	-----	--	-----	--	-----	--	-----	--	-----	--	-----	--	-----	--	-----	--	-----	--	-----	--	-----	--	-----	--	-----	--	-----	--	-----	--	-----	--	-----	--	-----	--	-----	--	-----	--	-----	--	-----	--	-----	--	-----	--	-----	--	-----	--	-----	--	-----	--	-----	--	-----	--	-----	--	-----	--	-----	--	-----	--	-----	--	-----	--	-----	--	-----	--	-----	--	-----	--	-----	--	-----	--	-----	--	-----	--	-----	--	-----	--	-----	--	-----	--	-----	--	-----	--	-----	--	-----	--	-----	--	-----	--	-----	--	-----	--	-----	--	-----	--	-----	--	-----	--	-----	--	-----	--	-----	--	-----	--	-----	--	-----	--	-----	--	-----	--	-----	--	-----	--	-----	--	-----	--	-----	--	-----	--	-----	--	-----	--	-----	--	-----	--	-----	--	-----	--	-----	--	-----	--	-----	--	-----	--	-----	--	-----	--	-----	--	-----	--	-----	--	-----	--	-----	--	-----	--	-----	--	-----	--	-----	--	-----	--	-----	--	-----	--	-----	--	-----	--	-----	--	-----	--	-----	--	-----	--	-----	--	-----	--	-----	--	-----	--	-----	--	-----	--	-----	--	-----	--	-----	--	-----	--	-----	--	-----	--	-----	--	-----	--	-----	--	-----	--	-----	--	-----	--	-----	--	-----	--	-----	--	-----	--	-----	--	-----	--	-----	--	-----	--	-----	--	-----	--	-----	--	-----	--	-----	--	-----	--	-----	--	-----	--	-----	--	-----	--	-----	--	-----	--	-----	--	-----	--	-----	--	-----	--	-----	--	-----	--	-----	--	-----	--	-----	--	-----	--	-----	--	-----	--	-----	--	-----	--	-----	--	-----	--	-----	--	-----	--	-----	--	-----	--	-----	--	-----	--	-----	--	-----	--	-----	--	-----	--	-----	--	-----	--	-----	--	-----	--	-----	--	-----	--	-----	--	-----	--	-----	--	-----	--	-----	--	-----	--	-----	--	-----	--	-----	--	-----	--	-----	--	-----	--	-----	--	-----	--	-----	--	-----	--	-----	--	-----	--	-----	--	-----	--	-----	--	-----	--	-----	--	-----	--	-----	--	-----	--	-----	--	-----	--	-----	--	-----	--	-----	--	-----	--	-----	--	-----	--	-----	--	-----	--	-----	--	-----	--	-----	--	-----	--	-----	--	-----	--	-----	--	-----	--	-----	--	-----	--	-----	--	-----	--	-----	--	-----	--	-----	--	-----	--	-----	--	-----	--	-----	--	-----	--	-----	--	-----	--	-----	--	-----	--	-----	--	-----	--	-----	--	-----	--	-----	--	-----	--	-----	--	-----	--	-----	--	-----	--	-----	--	-----	--	-----	--	-----	--	-----	--	-----	--	-----	--	-----	--	-----	--	-----	--	-----	--	-----	--	-----	--	-----	--	-----	--	-----	--	-----	--	-----	--	-----	--	-----	--	-----	--	-----	--	-----	--	-----	--	-----	--	-----	--	-----	--	-----	--	-----	--	-----	--	-----	--	-----	--	-----	--	-----	--	-----	--	-----	--	-----	--	-----	--	-----	--	-----	--	-----	--	-----	--	-----	--	-----	--	-----	--	-----	--	-----	--	-----	--	-----	--	-----	--	-----	--	-----	--	-----	--	-----	--	-----	--	-----	--	-----	--	-----	--	-----	--	-----	--	-----	--	-----	--	-----	--	-----	--	-----	--	-----	--	-----	--	-----	--	-----	--	-----	--	-----	--	-----	--	-----	--	-----	--	-----	--	-----	--	-----	--	-----	--	-----	--	-----	--	-----	--	-----	--	-----	--	-----	--	-----	--	-----	--	-----	--	-----	--	-----	--	-----	--	-----	--	-----	--	-----	--	-----	--	-----	--	-----	--	-----	--	-----	--	-----	--	-----	--	-----	--	-----	--	-----	--	-----	--	-----	--	-----	--	-----	--	-----	--	-----	--	-----	--	-----	--	-----	--	-----	--	-----	--	-----	--	-----	--	-----	--	-----	--	-----	--	-----	--	-----	--	-----	--	-----	--	-----	--	-----	--	-----	--	-----	--	-----	--	-----	--	-----	--	-----	--	-----	--	-----	--	-----	--	-----	--	-----	--	-----	--	-----	--	-----	--	-----	--	-----	--	-----	--	-----	--	-----	--	-----	--	-----	--	-----	--	-----	--	-----	--	-----	--	-----	--	-----	--	-----	--	-----	--	-----	--	-----	--	-----	--	-----	--	-----	--	-----	--	-----	--	-----	--	-----	--	-----	--	-----	--	-----	--	-----	--	-----	--	-----	--	-----	--	-----	--	-----	--	-----	--	-----	--	-----	--	-----	--	-----	--	-----	--	-----	--	-----	--	-----	--	-----	--	-----	--	-----	--	-----	--	-----	--	-----	--	-----	--	-----	--	-----	--	-----	--	-----	--	-----	--	-----	--	-----	--	-----	--	-----	--	-----	--	-----	--	-----	--	-----	--	-----	--	-----	--	-----	--	-----	--	-----	--	-----	--	-----	--	-----	--	-----	--	-----	--	-----	--	-----	--	-----	--	-----	--	-----	--	-----	--	-----	--	-----	--	-----	--	-----	--	-----	--	-----	--	-----	--	-----	--	-----	--	-----	--	-----	--	-----	--	-----	--	-----	--	-----	--	-----	--	-----	--	-----	--	-----	--	-----	--	-----	--	-----	--	-----	--	-----	--	-----	--	-----	--	-----	--	-----	--	-----	--	-----	--	-----	--	-----	--	-----	--	-----	--	-----	--	-----	--	-----	--	-----	--	-----	--	-----	--	-----	--	-----	--	-----	--	-----	--	-----	--	-----	--	-----	--	-----	--	-----	--	-----	--	-----	--	-----	--	-----	--	-----	--	-----	--	-----	--	-----	--	-----	--	-----	--	-----	--	-----	--	-----	--	-----	--	-----	--	-----	--	-----	--	-----	--	-----	--	-----	--	-----	--	-----	--	-----	--	-----	--	-----	--	-----	--	-----	--	-----	--	-----	--	-----	--	-----	--	-----	--	-----	--	-----	--	-----	--	-----	--	-----	--	-----	--	-----	--	-----	--	-----	--	-----	--	-----	--	-----	--	-----	--	-----	--	-----	--	-----	--	-----	--	-----	--	-----	--	-----	--	-----	--	-----	--	-----	--	-----	--	-----	--	-----	--	-----	--	-----	--	-----	--	-----	--	-----	--	-----	--	-----	--	-----	--	-----	--	-----	--	-----	--	-----	--	-----	--	-----	--	-----	--	-----	--	-----	--	-----	--	-----	--	-----	--	-----	--	-----	--	-----	--	-----	--	-----	--	-----	--	-----	--	-----	--	-----	--	-----	--	-----	--	-----	--	-----	--	-----	--	-----	--	-----	--	-----	--	-----	--	-----	--	-----	--	-----	--	-----	--	-----	--	-----	--	-----	--	-----	--	-----	--	-----	--	-----	--	-----	--	-----	--	-----	--	-----	--	-----	--	-----	--	-----	--	-----	--	-----	--	-----	--	-----	--	-----	--	-----	--	-----	--	-----	--	-----	--	-----	--	-----	--	-----	--	-----	--	-----	--	-----	--	-----	--	-----	--	-----	--	-----	--	-----	--	-----	--	-----	--	-----	--	-----	--	-----	--	-----	--	-----	--	-----	--	-----	--	-----	--	-----	--	-----	--	-----	--	-----	--	-----	--	-----	--	-----	--	-----	--	-----	--	-----	--	-----	--	-----	--	-----	--	-----	--	-----	--	-----	--	-----	--	-----	--	-----	--	-----	--	-----	--	-----	--	-----	--	-----	--	-----	--	-----	--	-----	--	-----	--	-----	--	-----	--	-----	--	-----	--	-----	--	-----	--	-----	--	-----	--	-----	--	-----	--	-----	--	-----	--	-----	--	-----	--	-----	--	-----	--	-----	--	-----	--	-----	--	-----	--	-----	--	-----	--	-----	--	-----	--	-----	--	-----	--	-----	--	-----	--	-----	--	-----	--	-----	--	-----	--	-----	--	-----	--	-----	--	-----	--	-----	--	-----	--	-----	--	-----	--	-----	--	-----	--	-----	--	-----	--	-----	--	-----	--	-----	--	-----	--	-----	--	-----	--	-----	--	-----	--	-----	--	-----	--	-----	--	-----	--	-----	--	-----	--	-----	--	-----	--	-----	--	-----	--	-----	--	-----	--	-----	--	-----	--	-----	--	-----	--	-----	--	-----	--	-----	--	-----	--	-----	--	-----	--	-----	--	-----	--	-----	--	-----	--	-----	--	-----	--	-----	--	-----	--	-----	--	-----	--	-----	--	-----	--	-----	--	-----	--	-----	--	-----	--	-----	--	-----	--	-----	--	-----	--	-----	--	-----	--	-----	--	-----	--	-----	--	-----	--	-----	--	-----	--	-----	--	-----	--	-----	--	-----	--	-----	--	-----	--	-----	--	-----	--	-----	--	-----	--	-----	--	-----	--	-----	--	-----	--	-----	--	-----	--	-----	--	-----	--	-----	--	-----	--	-----	--	-----	--	-----	--	-----	--	-----	--	-----	--	-----	--	-----	--	-----	--	-----	--	-----	--	-----	--	-----	--	-----	--	-----	--	-----	--	-----	--	-----	--	-----	--	-----	--	-----	--	-----	--	-----	--	-----	--	-----	--	-----	--	-----	--	-----	--	-----	--	-----	--	-----	--	-----	--	-----	--	-----	--	-----	--	-----	--	-----	--	-----	--	-----	--	-----	--	-----	--	-----	--	-----	--	-----	--	-----	--	-----	--	-----	--	------	--	------	--	------	--	------	--	------	--	------	--	------	--	------	--	------	--	------	--	------	--	------	--	------	--	------	--	------	--	------	--	------	--	------	--	------	--	------	--	------	--	------	--	------	--	------	--	------	--	------	--	------	--	------	--	------	--	------	--	------	--	------	--	------	--	------	--	------	--	------	--	------	--	------	--	------	--	------	--	------	--	------	--	------	--	------	--	------	--	------	--	------	--	------	--	------	--	------	--	------	--	------	--	------	--	------	--	------	--	------	--	------	--	------	--	------	--	------	--	------	--	------	--	------	--	------	--	------	--	------	--	------	--	------	--	------	--	------	--	------	--	------	--	------	--	------	--	------	--	------	--	------	--	------	--	------	--	------	--	------	--	------	--	------	--	------	--	------	--	------	--	------	--	------	--	------	--	------	--	------	--	------	--	------	--	------	--	------	--	------	--	------	--	------	--	------	--	------	--	------	--	------	--	------	--	------	--	------	--	------	--	------	--	------	--	------	--	------	--	------	--	------	--	------	--	------	--	------	--	------	--	------	--	------	--	------	--	------	--	------	--	------	--	------	--	------	--	------	--